

This product is part of a range of over 3000 daily living aids available from NRS Healthcare.

To view the full range, please visit our website:
www.nrshealthcare.co.uk, or request a catalogue using the number below.

NRS Healthcare,
Sherwood House,
Cartwright Way,
Forest Business Park,
Bardon Hill,
Coalville,
Leicestershire,
LE67 1UB,
United Kingdom.
Tel. Head Office: 0330 100 0098
Tel. Customer Services: 0345 121 8111
Email: customerservice@nrshealthcare.co.uk

www.nrshealthcare.co.uk



User Instructions

M78652 - 2in1 Adjustable Width Bed Stick

Maximum User Weight



General Safety Warning

Please ensure these instructions are fully read and implemented. Failure to do so may result in injury to the user. Retain in a safe place for future reference.

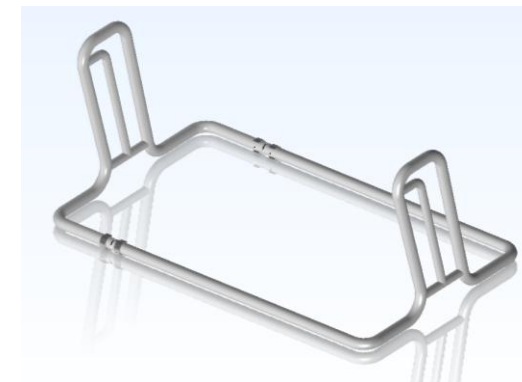

Intended Use

The 2in1 Adjustable Width Bed Stick provides a stable support to help clients move themselves to a sitting position and assist them getting in and out of bed. This device is suitable for both divan and slatted domestic beds and is suitable for all bed sizes from single to king-size. The product also complies with MHRA Guidance - Safe Use of Bedrails DB2006/06 for Adults and Children

Unpacking

- This product requires assembly before use.
- No tools are required.
- Remove the product from its packaging; Check for damage. If you see any, or suspect a fault, do not assemble the product; contact your supplier immediately.
- Check all parts are present - see contents list.

Contents	
Description	Qty
Bed stick Handle - Short	1
Bed Stick Handle - Long	1
Extension Tube	2
E - Clip	4

Safety Precautions

- This product complies with MHRA Guidance - Safe Use of Bedrails DB2006/06 for Adults and Children
- It is not designed for use with profiling beds.
- Please ensure the user does not exceed the maximum user weight 190kg (30 stones).
- Ensure the mattress is resting firmly against the bed rail handle.

- Check the bedrail is in the correct position and is stable and secure before use.
- **Important safety note:** There must be a gap of at least 250mm from the headboard to the Bed Rail, and the mattress should rest against the handle of the grab rail when fitted to reduce the risk of head/limb entrapment.

Installation Instructions

1. Assemble the Bed Stick by fitting the two Extension Tubes into the Long Bed Stick handle using the correct holes to suit the bed size - see diags.1 & 2, and secure with e-clips.
2. Fit the Short Handle onto the extension tubes using the appropriate holes to ensure the mattress is resting firmly against the Bed Stick Handle, to prevent the risk of entrapment. See Diag.3

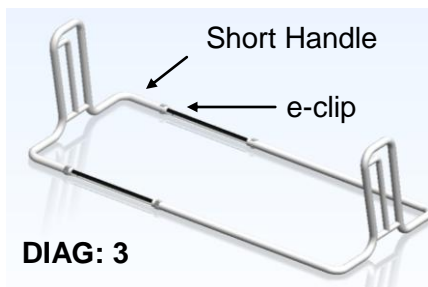
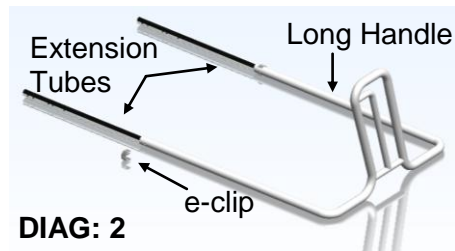
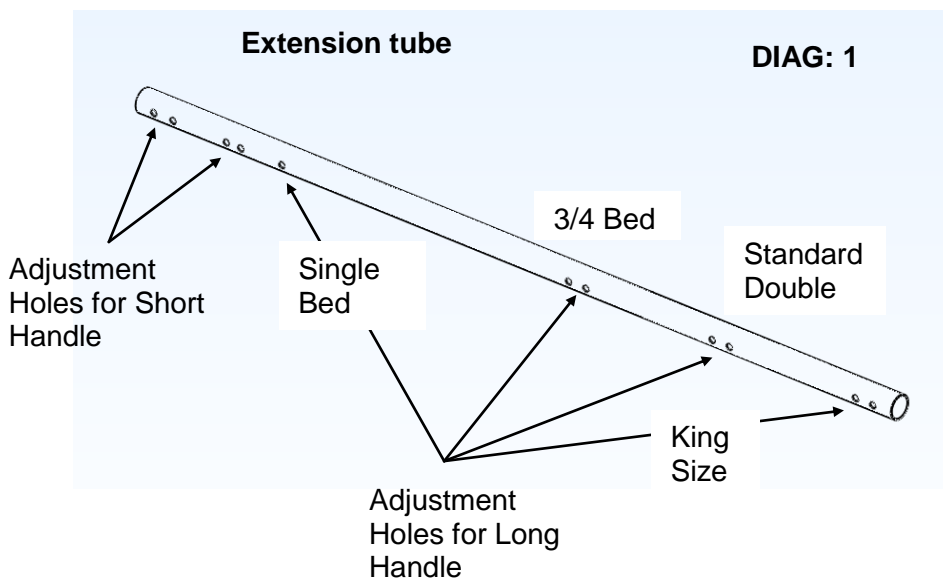

3. Place the bed stick onto the bed base with the angle of the handle pointing away from the user. The position of the device (which should ideally be based on a clinical assessment) should be such that when placed under the mattress with the handle fitted, the client (from a lying position) should be able to reach the handle without stretching. See Diag 4. Please also see important safety note for positioning instructions.

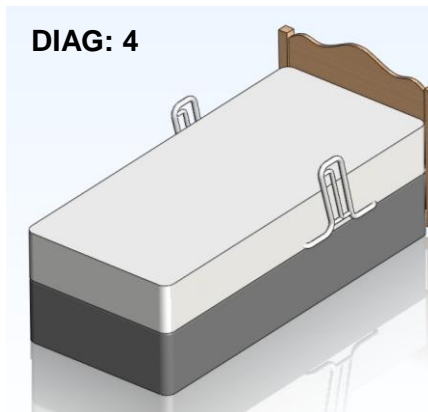

4. Note the Handles can be reversed if not required on the opposite side of the bed, see diagram 5, this also gives additional stability on divan beds.

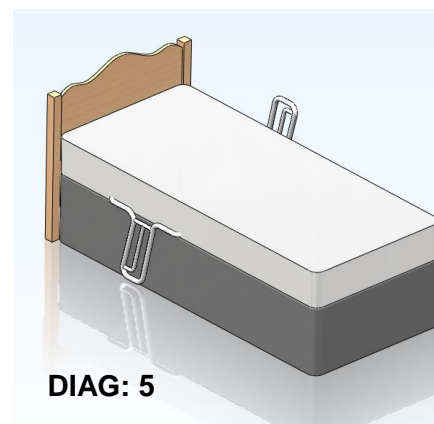

Product Maintenance & Cleaning

- Clean regularly, wiping down with a soft cloth and a mild detergent/disinfectant solution
- Do not use abrasive cleaners
- This product can be autoclaved up to 80°C
- Inspect on a regular basis the stability and rigidity of the product.
- Check clips are fitted correctly and the product is positioned correctly on the bed.
-