

Assembly Instructions

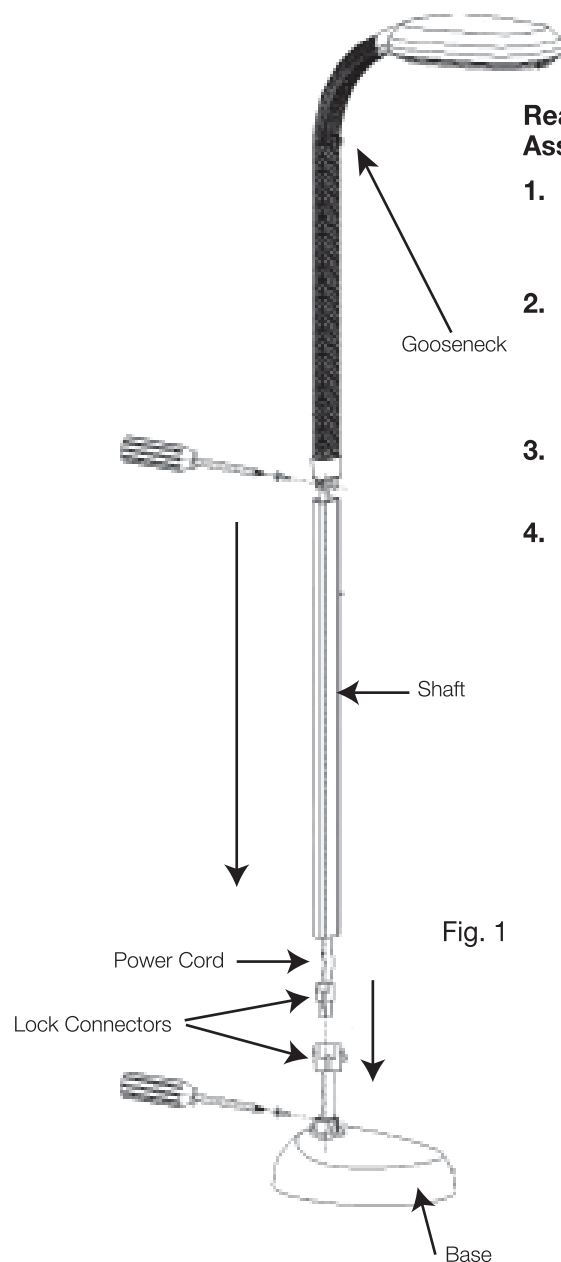

Read Instructions Carefully Before Assembly:

1. Connect the two ends of the **Power Cord (between the Base and the Shaft)** using the lock connectors.
2. Carefully tuck excess **Power Cord** into the **Shaft**.
⚠ WARNING: DO NOT CUT OR SHORTEN THE POWER CORD.
3. Insert the **Gooseneck** and the **Shaft** into the **Base**.
4. Check direction of the lamp and the hole on the **Base**, then use a Phillips Head Screwdriver (not included) to tighten the screw into the hole.

⚠ CAUTION: BE VERY CAREFUL NOT TO PINCH ANY PART OF THE CORD BETWEEN ANY METAL PIECES.

Fig. 1



Lifemax Ltd
Unit 1 Pipers Court,
Thatcham,
Berkshire, RG19 4ER
www.lifemaxuk.co.uk

Bulb Replacement Instructions

Installation

1. Unplug lamp from power source.
2. Firmly hold base (B) and push bulb (C) into the socket (A).
3. Be sure bulb is firmly seated in the socket (see below) and snapped into the metal bulb clip (D).
4. Attaching the parabolic grid diffuser:
 - Remove grid diffuser from protective plastic bag
 - Insert plastic pegs at bottom of grid diffuser into openings near bulb socket.
 - Snap tab into place

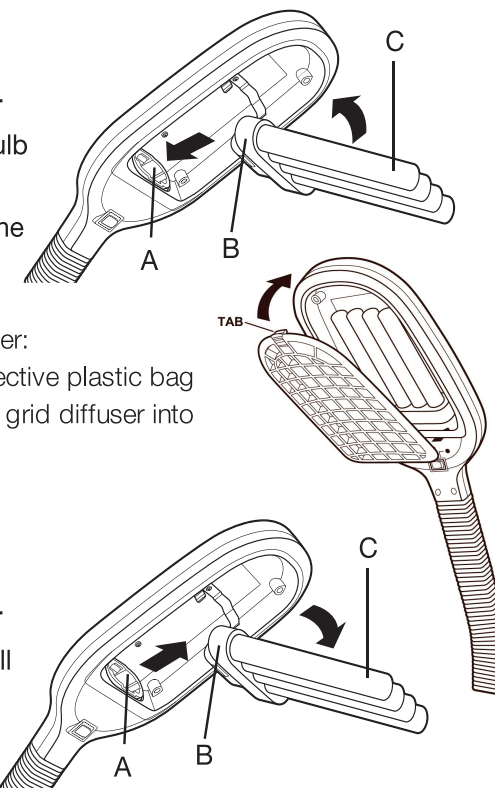

Removal

1. Unplug lamp from power source.
2. Firmly hold bulb base (B) and pull bulb (C) from the socket (A) in an outward motion.

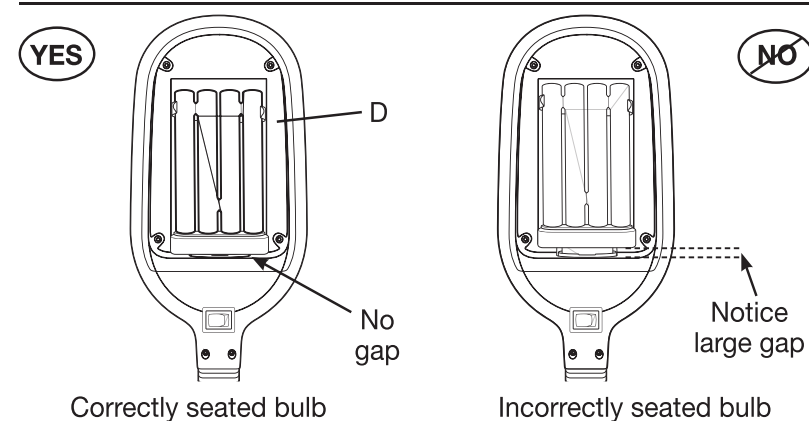

⚠ CAUTION: ALWAYS UNPLUG LAMP BEFORE PERFORMING BULB REPLACEMENT OR INSTALLATION.

Assembly Instructions

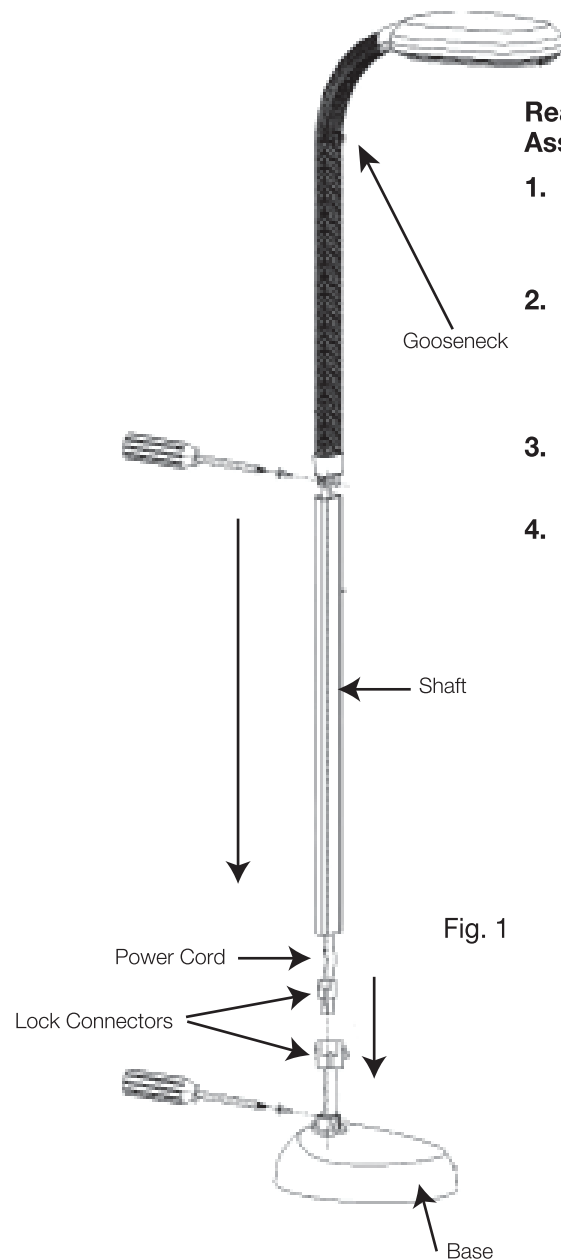

Read Instructions Carefully Before Assembly:

1. Connect the two ends of the **Power Cord (between the Base and the Shaft)** using the lock connectors.
2. Carefully tuck excess **Power Cord** into the **Shaft**.
⚠ WARNING: DO NOT CUT OR SHORTEN THE POWER CORD.
3. Insert the **Gooseneck** and the **Shaft** into the **Base**.
4. Check direction of the lamp and the hole on the **Base**, then use a Phillips Head Screwdriver (not included) to tighten the screw into the hole.

⚠ CAUTION: BE VERY CAREFUL NOT TO PINCH ANY PART OF THE CORD BETWEEN ANY METAL PIECES.

Fig. 1



Lifemax Ltd
Unit 1 Pipers Court,
Thatcham,
Berkshire, RG19 4ER
www.lifemaxuk.co.uk

250.3X

Bulb Replacement Instructions

Installation

1. Unplug lamp from power source.
2. Firmly hold base (B) and push bulb (C) into the socket (A).
3. Be sure bulb is firmly seated in the socket (see below) and snapped into the metal bulb clip (D).
4. Attaching the parabolic grid diffuser:
 - Remove grid diffuser from protective plastic bag
 - Insert plastic pegs at bottom of grid diffuser into openings near bulb socket.
 - Snap tab into place

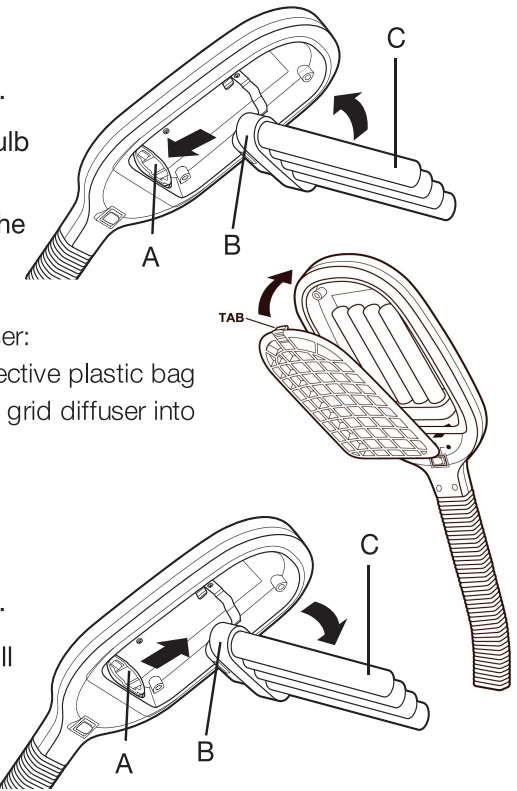

Removal

1. Unplug lamp from power source.
2. Firmly hold bulb base (B) and pull bulb (C) from the socket (A) in an outward motion.

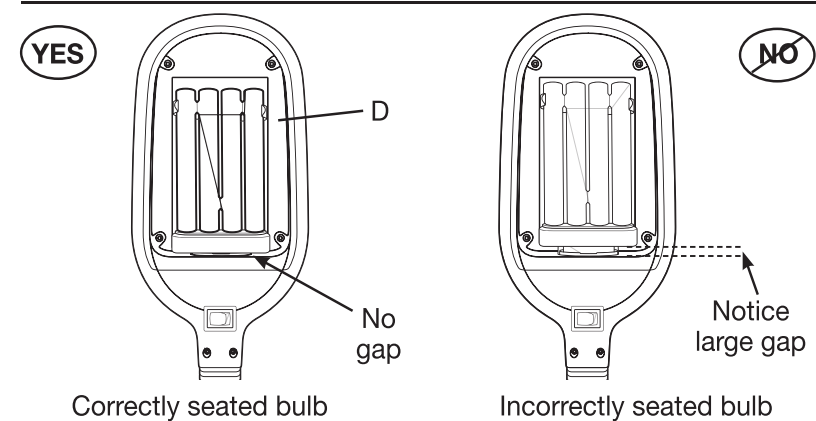

⚠ CAUTION: ALWAYS UNPLUG LAMP BEFORE PERFORMING BULB REPLACEMENT OR INSTALLATION.