

# USER INSTRUCTIONS

## NRS DOUBLE EASYFIT BEDGUARD

P78222

NRS Double EasyFit Bedguard

### ⚠ General Safety Warning ⚠

Please make sure that you read and follow these instructions carefully. Keep these instructions in a safe place for future reference.

## 1. INTENDED USE

The NRS Double EasyFit Bedguard is designed to prevent adult users (taller than 1.46m) from rolling out of bed. The bedguard has adjustable sliding guard mechanisms, which can be extended or retracted for easy access on and off either side of the bed.

The bedguard can be used on divan and slatted beds, from single to king size. The bedguard rail sections can be removed to make bed making easy.



## 2. SAFETY

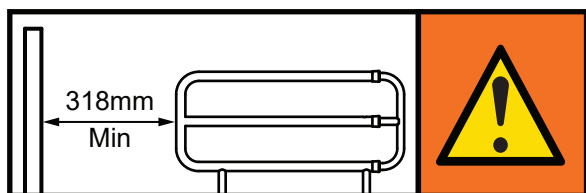

**WARNING:** To avoid possible entrapment, you must always position the product a minimum of 318mm from the headboard or footboard.

**WARNING:** To avoid possible entrapment, you must always position the product a minimum of 318mm from solid objects/furniture such as bedside drawers or cabinets.

**WARNING:** NRS recommends a maximum mattress thickness of 254mm (10"). The distance from the top of the uncompressed mattress to the top of the bedguard rail should be at least 220mm.

**YOU MUST** carry out a risk assessment to assess the use and suitability of the bed rail in relation to the users physical and cognitive ability, as well as the surrounding environment.

**DO NOT** install this product to a damaged bed.

**MAKE SURE** there is no gap between the bed rail and the mattress.

**MAKE SURE** The bedguard is always be positioned as close as possible to the mattress, to prevent user entrapment.

**DO NOT** fit this product to height adjustable or profiling beds.

**DO NOT** use this product as a bedrail. It will not support the users bodyweight.

**Note:** Some tasks within these instructions may require two people.

## 3. UNPACKING

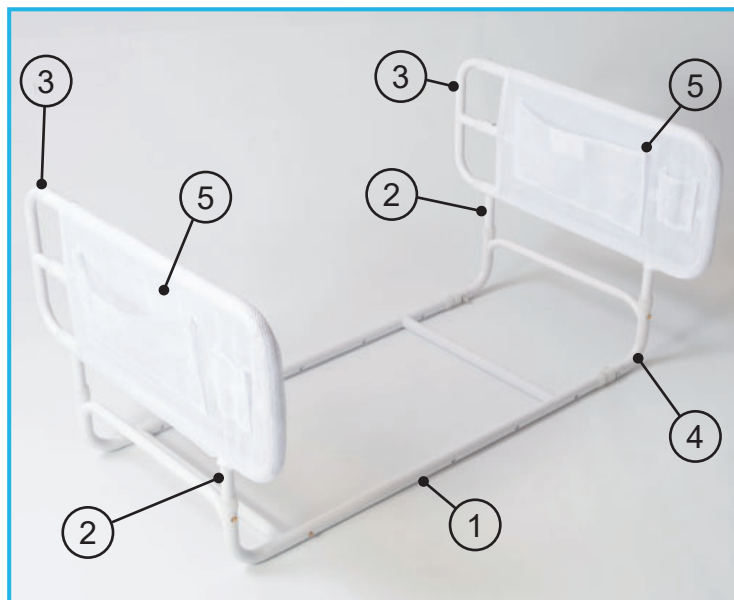

Remove the packaging and check all parts carefully. Contact your supplier immediately if parts are missing or damaged and do not try and assemble.

### 3.1 Contents:

1. Base-frame
2. Bedguard Rail x 2
3. Bedguard Extension Rail x 2
4. Base Adjustment Rail
5. Mesh Cover x 2

4. ASSEMBLY AND INSTALLATION

4.1 Fitting the Bedguard Rail

The bedguard is packaged in three parts. To assemble, attach the bedguard rails to the base-frame assembly as follows:

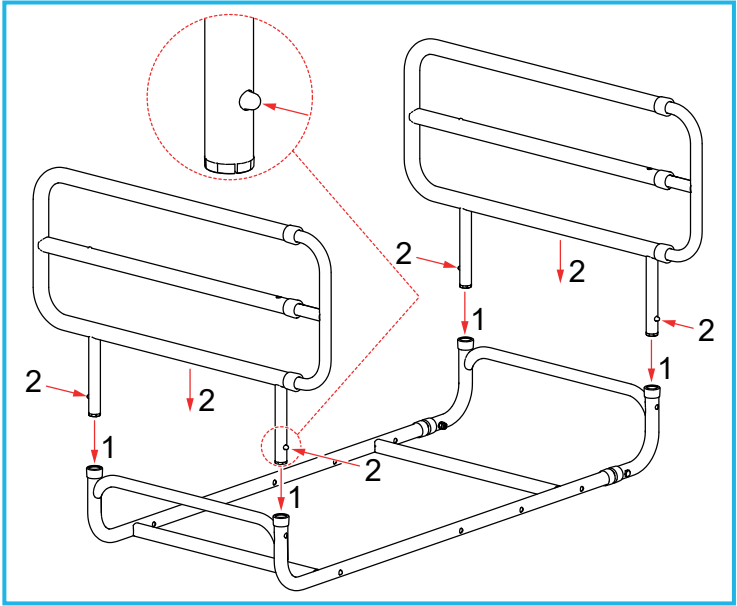

- 1. Slot the bedguard rail into the base-frame assembly.
- 2. Push and hold the bedguard rail button-clips, then push the bedguard rail into the base-frame assembly until the button-clips click into position in the base frame holes.
- 3. Repeat the steps for the opposite side.

**Note:** Make sure that the button-clips have fully engaged into the holes.

4.2 Adjusting the base width:

**Note:** The following steps may require two people.

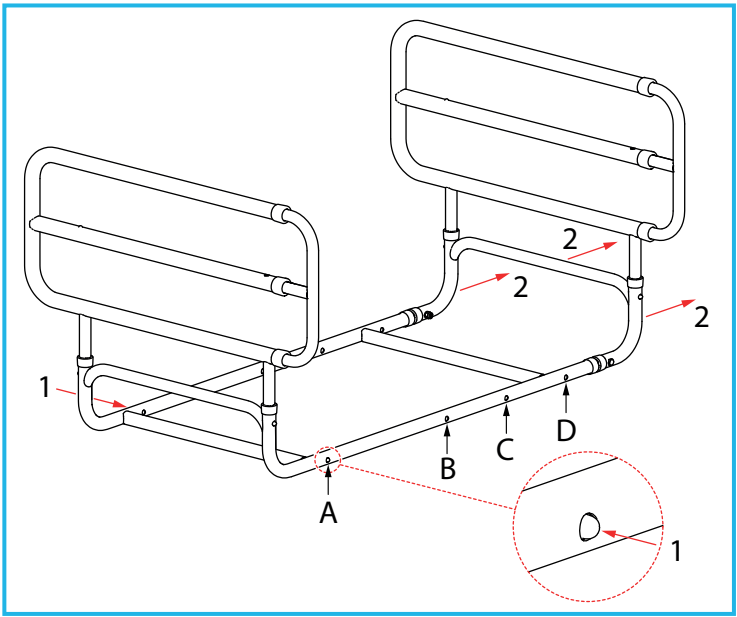

	Standard Single	Small Double	Standard Double	King Size
Bed Width	900mm	1200mm	1350mm	1500mm
Position	A	B	C	D

- 1. Push and hold the button-clips on the base adjustment rail.
- 2. Slide the base adjustment rail out from the base-frame until the button-clips click into the required hole positions for your bed.

**Note:** Some wood framed beds may not allow the adjustment rail to extend fully for the button-clips to engage, this will not affect the safety of the bedguard.

4.3 Fitting the Bedguard to the bed:

**Note:** The following steps may require two people.



Remove the mattress and place the bedguard on the bed base.

4.4 Position the Bedguard

Position the bed rail so the user can reach the handle from a relaxed lying position without having to stretch.

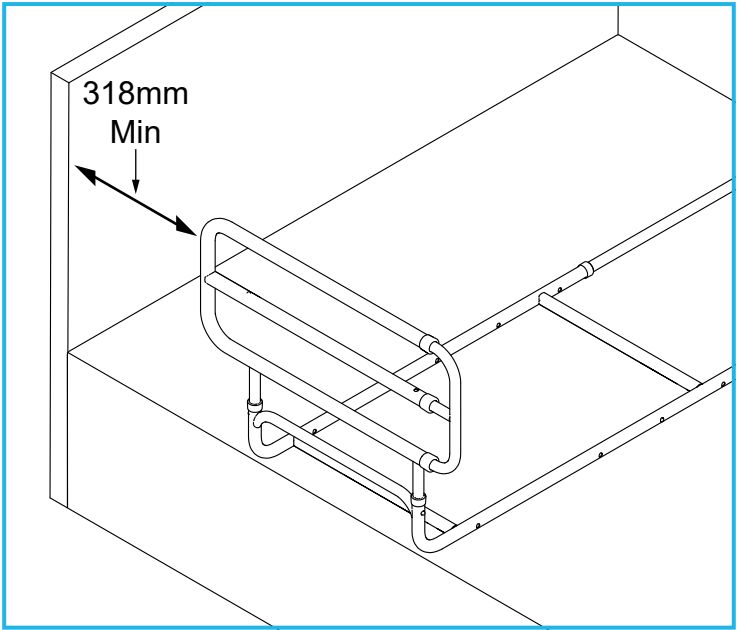

**WARNING:** To avoid possible entrapment, you must always position the product a minimum of 318mm from the headboard or footboard.

**WARNING:** To avoid possible entrapment, you must always position the product a minimum of 318mm from solid objects/furniture such as bedside drawers or cabinets.

## 4.5 Replace the Mattress



Replace the mattress on top of the bedguard.

**WARNING:** The bedguard must always be positioned with the extending bedguard rails facing away from the headboard.

## 5. OPERATION AND USE

### 5.1 Extending the Bedguard Rails

The bedguards can be extended to give the user better protection from bed roll-out.

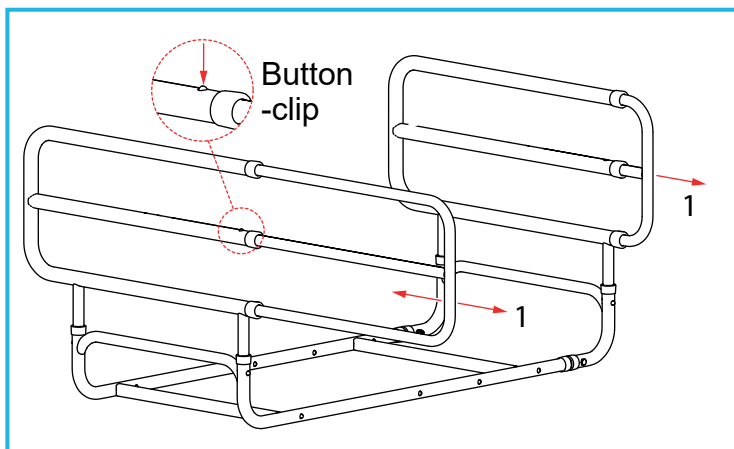

To extend the bedguards, pull the bedguard extension rail out from the main bedguard rail until the bedguard extension rail button-clip clicks into position.

**Note:** Make sure that the button-clip has fully engaged into the hole.

### 5.2 Retracting the Bedguard Extension Rail

The bedguard extension rail must be closed to let the user exit the bed.

To close the bedguard extension rail, press and hold the button-clip, then slide the bedguard extension into the main bedguard rail.

### 5.3 Remove the Bedguard Rail

The bedguard rails can be removed to enable the user to make the bed.

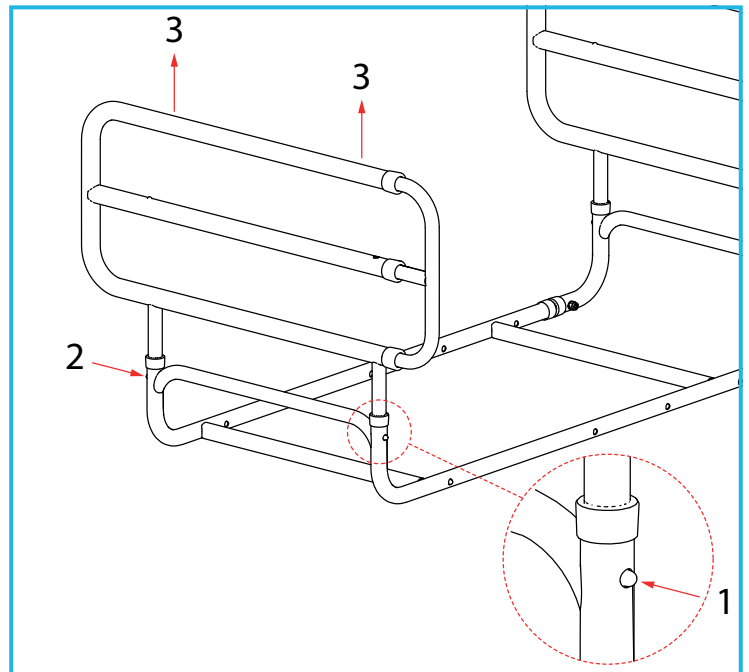

1. Push and hold the right-hand side bedguard rail button-clip, then pull the bedguard rail until the button-clip disengages from the hole.
2. Repeat step 1 for the left-hand side.
3. Make sure both button-clips have disengaged from the holes, then pull the bedguard rail out from the base frame.
4. To refit the bedguard rail, refer to Section 4.1.

### 5.4 Remove the Mesh Cover

The bedguard is supplied with the mesh cover fitted to the bedguard rails, to remove for cleaning, please do the following:



Undo the Velcro fastener and slide the mesh cover off the bedguard rail.

### 5.5 Refit the Mesh Cover

1. Slide the mesh cover onto the bedguard rail and secure with the Velcro fastener.
2. Make sure that the mesh cover is fully secure before use.



## 6. CLEANING

### 6.1 Cleaning the Bedguard

**Note:** Please check the suitability of the cleaning products before use. Do not use abrasive cleaners or cloths as these could permanently damage the surface and invalidate any warranty.

1. Clean regularly using a general purpose, neutral detergent and warm water.
2. To disinfect, wipe with a dilute bleach solution and rinse with fresh water.
3. Allow the product to dry fully before use or storage.

### 6.2 Cleaning the Mesh Covers

1. Hand-wash the mesh covers using a mild fabric detergent and warm water.
2. Rinse the mesh covers with warm water.
3. Allow the product to dry fully before use or storage.

## 7. MAINTENANCE

Check the bedguard is correctly positioned and that all button-clips have engaged securely.

Inspect the product for signs of wear or damage at regular intervals. Any suspected faults or damage must be reported to the supplier and the product taken out of use immediately.

## 8. ACCESSORIES & SPARE PARTS

**P42744:** Spare Mesh Cover (white).

For more details please visit our website:

[www.nrshealthcare.co.uk](http://www.nrshealthcare.co.uk) or call Customer Services.

## 9. PRODUCT DISPOSAL

This product should be thoroughly cleaned prior to disposal.

This product is manufactured from metal and plastic and can be disposed of through Local Authority Household Waste and Recycling Centres or through Local Trade Waste Collectors.

## 10. PRODUCT GUARANTEE

NRS Healthcare guarantee this product for a period of 12 months, from the date of purchase, against faulty materials and workmanship.

This guarantee does not cover; fair wear & tear, abuse, misuse, interference or tampering with any part of the product.

Any guarantee issued by NRS Healthcare does not affect your statutory rights.

If you have any problems with our products, please contact us at the address below.

If you have experienced an injury, contact us but feel free to contact the Medical and Healthcare products Regulatory Agency at:

[devices.regulatory@mhra.gov.uk](mailto:devices.regulatory@mhra.gov.uk)



**NRS HEALTHCARE** Sherwood House,  
Cartwright Way, Forest Business Park, Bardon  
Hill, Coalville, Leicestershire, LE67 1UB, UK.



**NRS HEALTHCARE** 4C Altona Road, Blaris  
Industrial Estate, Lisburn, Co Antrim,  
Northern Ireland BT27 5QB

Tel: Customer Services: 0345 121 8111

Email: [customerservice@nrshealthcare.co.uk](mailto:customerservice@nrshealthcare.co.uk)

**NRS Healthcare** is a leading supplier of community equipment and daily living aids.

Please visit one of our websites to view our full range of products:

[www.healthcarepro.co.uk](http://www.healthcarepro.co.uk) or [www.completecareshop.co.uk](http://www.completecareshop.co.uk)