

INTENDED USES

The Buckingham Walking Frame Caddy consists of a tray and container, which allows you to safely carry personal items and meals easily and with confidence. Simple to attach to virtually all non-folding wheeled walking frames it is light but sturdy, easy to clean and will not upset the balance of the frame.

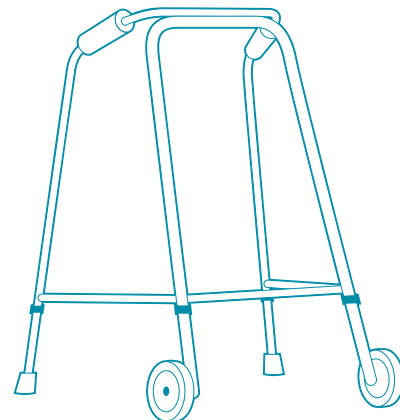

FITTING THE CADDY TO A WALKING FRAME

This product has been designed for use with non-folding, wheeled walking frames.

FOR FRAMES WITH A DOUBLE BAR ACROSS FRONT

- Position the Caddy on the frame with the groove over the bars
- Push fit the Caddy onto the frame until it clicks into position

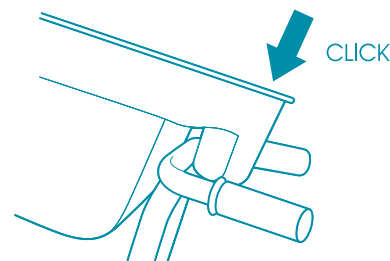

FOR FRAMES WITH A SINGLE BAR ACROSS THE FRONT

TO FIT THE CLIP

The supplied clips are required to secure the Caddy to the frame

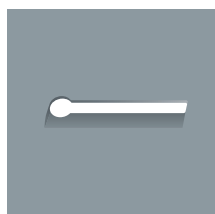
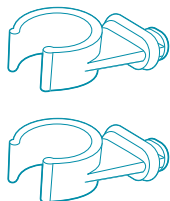

Prior to fitting – the clips supplied will need to be fitted into the channel at the rear of the Caddy

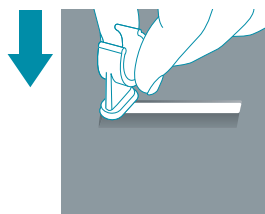

1. Locate the circular pin into the circular hole at the rear of the Caddy

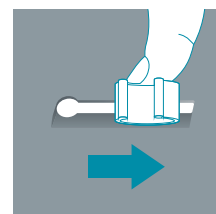

2. Slide along the channel

FOR STANDARD FRAMES

The clips should be angled outwards

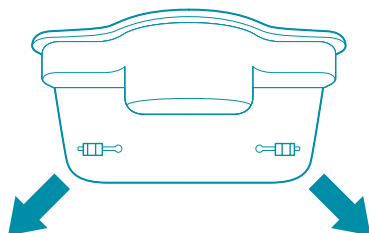

FOR NARROW FRAMES

The clips should be angled inwards, towards the centre of the Caddy

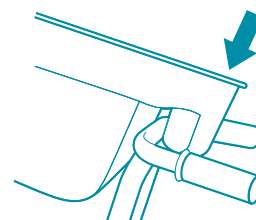
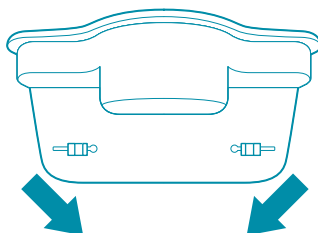

1. Push fit the Caddy onto the frame

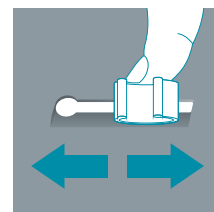

2. Slide the two clips along the channel so that they can be located onto the two front legs of the frame.

USING THE CADDY

- Once the Caddy is fitted, it can be used with or without the tray or cup holder.
- To fit the tray, simply position on top of the Caddy.
- There is no locking mechanism, it simply sits in position on top of the Caddy, secured by the lip on the tray..

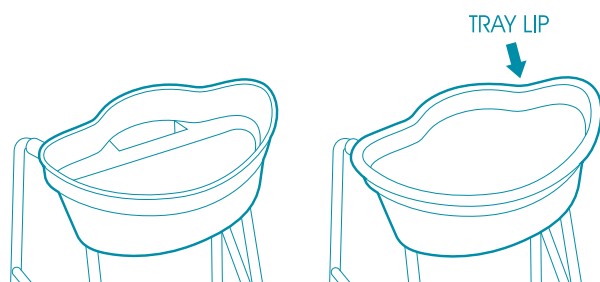

- When the tray is fitted, the cup holder can be fitted if required.
- The cup holder sits on the tray secured in position by the moulded rim on the tray.

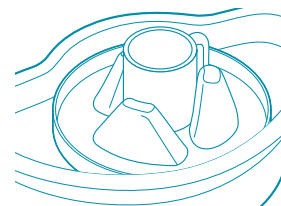
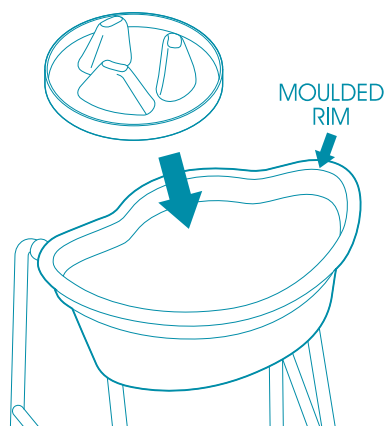

Note, the mug holder should always be used with the circular base positioned within the tray.

RESTRICTIONS FOR USE

The Buckingham Walking Frame Caddy has been designed solely to carry light, everyday personal items and should not be used to carry pets, small children, fuel of any kind, large volumes of liquid, heavy tools, domestic appliances or equipment.

- **Do not carry items that overhang the tray or are larger than the container.**
- **Do not to carry hot drinks on the tray without the Buckingham Mug Holder.**
- **Boiling drinks and teapots should not be carried using the Caddy.**
- **Only for use on wheeled walking frames.**
- **Maximum carrying weight 2kg (4.4lb).**

CLEANING

- All parts of the Caddy may be washed up to temperatures of 75°C
- All components of the Buckingham Caddy can be easily cleaned using either mild detergent and a cloth or a antibacterial wipe.



Scan and click to watch the video on your phone.

Chris says...

“We strive to help people remain independent by providing innovative products designed and made in the UK.”

Helping people to help themselves.



Find us on Facebook. Share your videos or tell us how you use your Caddy.
Facebook.com/BuckinghamHealthcare

Buckingham Healthcare

Unit 1, Gorcombe Farm, Thornicombe, Blandford Forum, Dorset, DT11 9AG

Email: info@buckinghamhealthcare.co.uk Tel: 01258 839122

Patented No: GB2397779

www.buckinghamhealthcare.co.uk

How it all Began...

The Buckingham Caddy was the first product designed by Occupational Therapist Chris Buckingham for Buckingham Healthcare. Chris is a qualified Occupational Therapist and came up with the idea for the Caddy whilst working on an elderly rehabilitation ward.

Many of Chris' patients were dependent upon a walking frame to walk, which meant that they were unable to safely carry anything at the same time. Using a wheeled trolley to carry items is not always a safe option for frame users and frustrated by the lack of any suitable product on the market to solve this problem, Chris got to work designing a solution herself.

The Buckingham Walking Frame Caddy consists of a tray and container, which allows you to safely carry personal items and meals easily and with confidence. Simple to attach to virtually all non-folding wheeled walking frames, it is light but sturdy, easy to clean and will not upset the balance of the frame.



buckingham
healthcare®



Helping people to help themselves

Chris Buckingham
LLB BSc MRCOT