

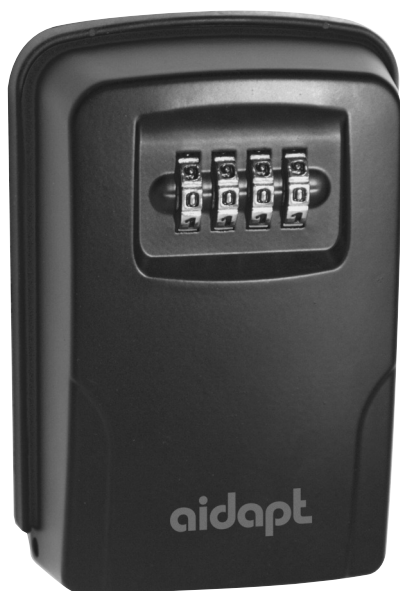

KEY SAFE

VM844A



Usage and Maintenance Instructions

INTRODUCTION

Thank you for deciding to purchase the Key Safe from Aidapt.

BEFORE USE

Carefully remove all packaging. Avoid using any knives or other sharp instruments as this may damage the item.

Check the product for any visible damage. If you see any damage or suspect a fault, do not use your product, but contact your supplier for support.

USAGE INSTRUCTIONS

To open the key safe:

1. Rotate dials to the correct combination (the default combination is set at the factory to 0-0-0-0)
2. Pull the door fully open and add or remove the keys
3. Close the door, rotate the dials at random to lock the safe.
4. To open set the combination to 0-0-0-0.

To change the combination:

PLEASE NOTE

THE CODE CANNOT BE RESET UNLESS THE SAFE IS OPENED. THERE IS NO OVERRIDE. AS SUCH IF YOU FORGET YOUR CODE THEN THE ONLY WAY TO OPEN THE SAFE IS TO GO THROUGH UP TO 1000 COMBINATIONS TO FIND YOUR CODE.

1. Open the Key Safe as normal. (See above)
2. Push the reset lever on the back of the door to the right and upwards (can be slightly stiff).
3. Rotate the dials to your desired new combination – ensure they are aligned correctly so that the code is entered accurately.
4. Push the RESET lever downwards and to the left (back to its original position).
5. Close the Key Safe and rotate the dials at random.

TEST YOUR CODE BEFORE MOUNTING THE KEY SAFE

See the next page for how to mount the unit

To wall mount the unit:

1. Open the Key Safe Door.
2. Position the lock on the desired surface.
3. Use level to verify the Key Safe is vertical.
4. Mark the position for the screw holes on the surface.
5. Remove the Key Safe.
6. Drill the holes in the surface.
7. Position the Key Safe, insert and tighten the screws.
8. Lock the Key Safe.

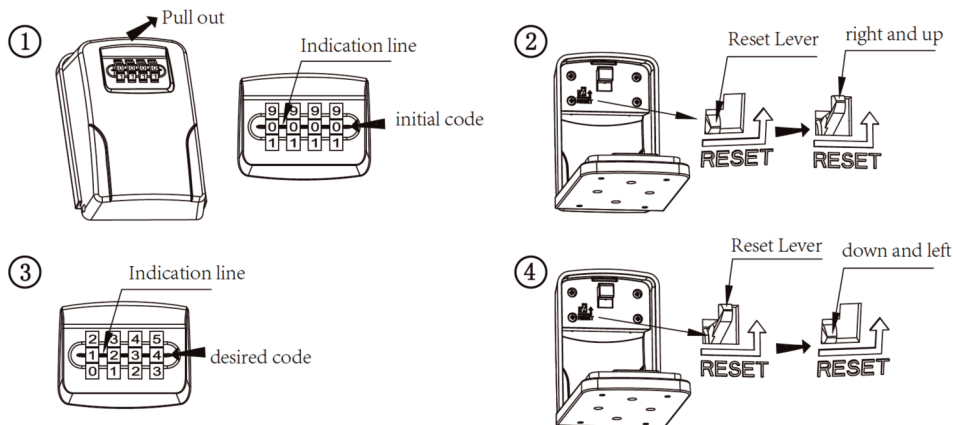

CLEANING

Clean your Key Safe using a mild detergent with a slightly damp, soft cloth only. Only use a mild detergent or disinfectant; never use an abrasive cleaner.

CARE & MAINTENANCE

Please make a safety check of the product at regular intervals or if you have any concerns.

REISSUE

If you reissue or are about to reissue this product, please thoroughly check all components for their safety.

If in any doubt, please do not issue or use, but immediately contact your supplier for service support.

IMPORTANT INFORMATION

The information given in this instruction booklet must not be taken as forming part of or establishing any contractual or other commitment by Aidapt Bathrooms Limited, Aidapt (Wales) Ltd or its agents or its subsidiaries and no warranty or representation concerning the information is given.

Please exercise common sense and do not take any unnecessary risks when using this product; as the user you must accept liability for safety when using the product.

Please do not hesitate to contact the person who issued this product to you or the manufacturer (detailed below) if you have any queries concerning the assembly/use of your product.

IMPORTANT

We do not recommend simple combinations such as 0-0-0-0 or 5-5-5-5. It is recommended that the dials are rotated weekly to keep them moving freely.

Aidapt Bathrooms Ltd, Lancots Lane, Sutton Oak, St Helens, WA9 3EX
Telephone: +44 (0) 1744 745 020 • Fax: +44 (0) 1744 745 001 • Web: www.aidapt.co.uk
Email: accounts@aidapt.co.uk • adaptations@aidapt.co.uk • sales@aidapt.co.uk