

User Instructions

M48453 Rise Easy Width Adjustable Mattress Elevator



General Safety Warning

Please ensure these instructions are fully read and understood before installation/use. Retain in a safe place for future reference.

CONTENTS

- 1. INTRODUCTION**
- 2. SAFETY PRECAUTIONS**
- 3. INTENDED USE**
- 4. PRODUCT DESCRIPTION**
- 5. UNPACKING**
- 6. INSTALLATION INSTRUCTIONS**
- 7. OPERATING INSTRUCTIONS**
- 8. FAULT FINDING**
- 9. CARE AND MAINTENANCE**
- 10. GUARANTEE**
- 11. SPARE PARTS LIST**
- 12. IMPORTANT INFORMATION**
- 13. TECHNICAL INFORMATION**

1 – Introduction

Thank you for purchasing the NRS Rise Easy Mattress Elevator. This product is designed to give many years continued service if properly used and maintained. If you have any problems or need advice regarding the product, please contact your supplier immediately. Alternatively, you can contact:

NRS Healthcare: 0345 121 8111 or Email: customerservice@nrshealthcare.co.uk

Before fitting the Rise Easy mattress elevator please ensure these instructions are fully read and understood.

2 - Safety Precautions

- **The Mattress Elevator has a safe working load of 40st (254Kg) total body weight**
- The Mattress Elevator must be assembled correctly according to the following assembly instructions and must be used in accordance with the instructions provided.
- The Mattress Elevator must be sitting stable and square to the bed.
- Check all securing straps are properly secured as described in section 6
- If the straps have been undone at any time always ensure they are re-secured before use.
- Before operating the product always check for any obstacles which may impede the mechanism
- Do not allow children to play with or operate the device
- When the product is not in use, disconnect the power from the mains supply.
- Keep all parts of your body clear from the lifting mechanism.
- Do not use any liquid or damp materials to clean electrical or mechanical parts.
- Always disconnect the mains plug prior to moving or cleaning.
- Ensure all plugs and electrical points are safely wired, dry and free from damage.
- Do not use if any cable or electrical connection is damaged.
- Do not operate the handset with wet hands, sharp or heavy objects.

3 – Intended Use

The Rise Easy Mattress Elevator is designed to fit most types of divan bed; it is width adjustable so that one size fits single and double beds. From 2' 6" (762mm) to 5' 0" (1524mm). Some types of beds e.g. metal framed, may not be suitable, if you are in any doubt, please contact your supplier before use.

Note the Rise Easy Mattress Elevator is not suitable for use with;

- Orthopaedic Mattresses.
- Slatted or sprung base divan beds

Not to be used in conjunction with any form of electric under blanket.

The Rise Easy Mattress elevator is designed for use in the home, residential care and nursing homes.

It should be noted that with prolonged use some damage to the mattress may occur. In such circumstances, a special mattress is available. Details of which can be obtained by contacting NRS Customer Services.

4 – Product Description

General;

The Rise Easy Mattress Elevator is designed to allow those confined in bed for long periods to sit or lie comfortably with a higher degree of independence.

The Mattress Elevator smoothly rises and reclines, the angle adjustment is operated via a simple to use hand control.

Frame; The Rise Easy Mattress Elevator is constructed from high quality steel tube and plate with a powder coat paint finish.

The raising and lowering action is via an actuator, which comes ready fitted. The mechanism has a built in anti crush device as standard. This device reduces the risk of entrapment between the base and pivoting section of the unit. You must, however use caution and take care when using the product

Handset; The product is operated via the simple to use, ergonomically designed, hand control. It has easy touch buttons with clear arrows for raising and lowering the unit.

Straps; The unit is fixed to the bed with four sets of straps and buckles which come ready assembled to the frame. Note the straps may limit access to divan drawers once fitted. If this is the case the straps can temporarily be undone, but must be properly re-secured immediately. Do not operate the Mattress elevator if all the straps are not securely fastened.

5 – Unpacking

Note: the packaging for this product is purpose built and should be retained if possible. Check all parts carefully before installing/using the product. Do not fit if any of the parts are damaged or missing. (See Contents list)

If you have a problem, contact your supplier to have the product returned.

The Rise Easy Mattress Elevator is pre-assembled and ready to be fitted to the bed.

CONTENTS LIST		
ITEM	DESCRIPTION	QTY.
1	Mattress Elevator assembly	1
2	Actuator Control Box (Fitted)	1
3	Hand control with cable (Fitted)	1
4	Black Strap – Short (Fitted)	2
5	Grey Strap – Long (Fitted)	2
6	Pin Clip	2
7	User Instructions (This Booklet)	1
8	Packing list and Test Certificate	1

6 – Installation Instructions

It is recommended that a fitted bottom sheet and a duvet are used in conjunction with the Mattress Elevator.

6.1 - Remove the mattress from the bed. Position the bed away from any wall or obstacle, if possible, to allow greater access to fit the mattress Elevator.

6.2 - Place the mattress elevator on the bed squarely, as shown in Diagram - 1

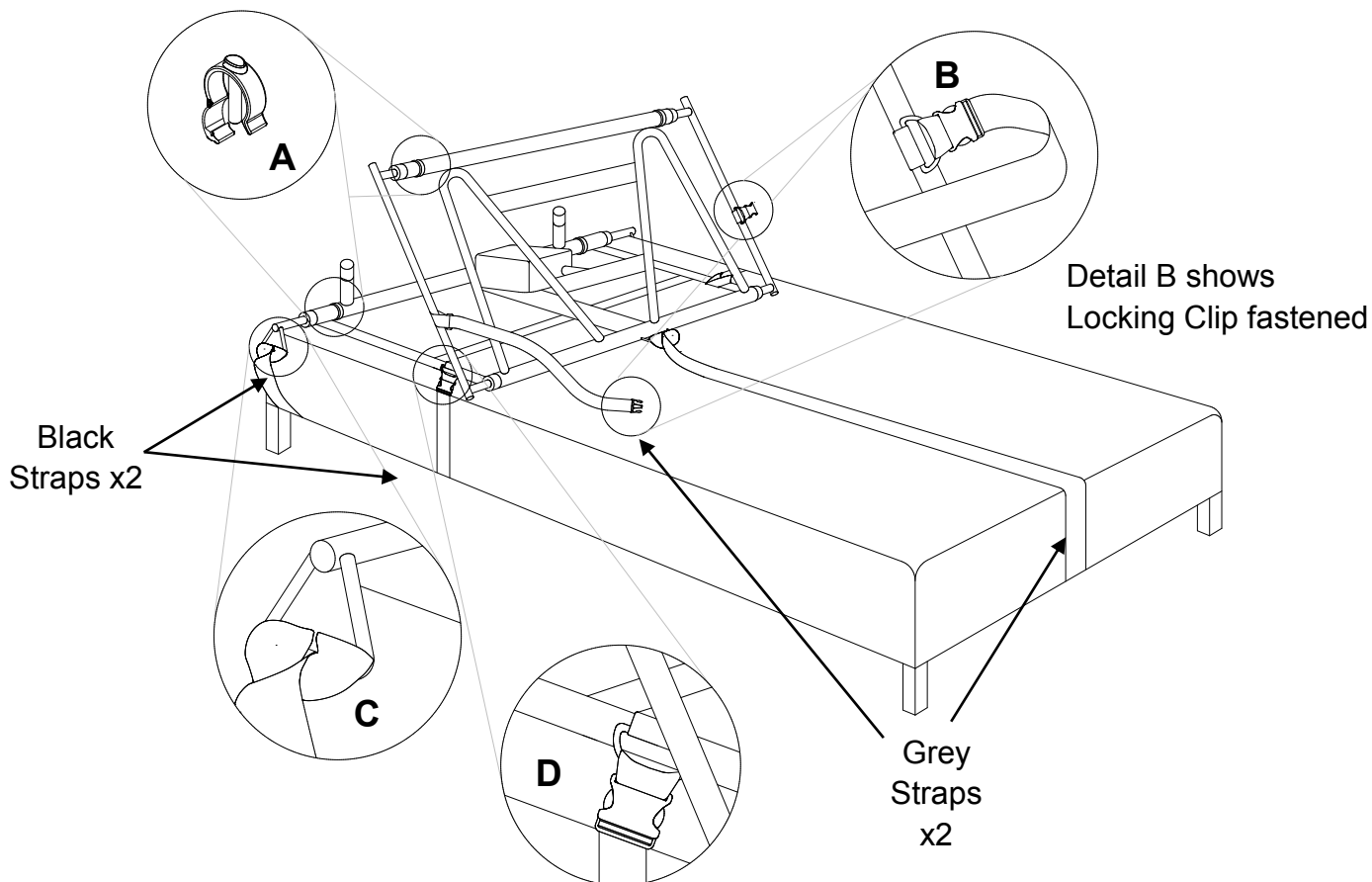

Diagram 1

6.3 – Position the side extension bars fitted to the rear of the Mattress Elevator (Refer to Detail A) by pulling out each bar to the desired bed width, turn the tubes so that the triangular sections are pointing downwards (Refer to Detail C), ensuring that you do not exceed the last punched hole on the extensions. Align the holes in the tubes and secure with the two pin clips supplied. Ensure the clips pass completely through the frame and extension bars and the hinged part of the clip is securely clipped in place.

6.4 - Remove the two pin clips which secure the two side extenders on the top of the unit (Refer to Detail A). Pull out the extenders so that they are level with the edge of the bed ensuring that you do not exceed the last punched hole on the frame. Re-insert the two pin clips as described above.

WARNING: Do not extend beyond the sides of the mattress, as this will reduce the supported area of the mattress.

Fitting to all bed size range - 2' 6" (762mm) to 5' 0" (1524mm)

6.5 - Take the black webbing strap, fitted to the rear, triangular, section of the frame, check it is securely fastened, then pass underneath the bed. Fasten the snap clip fitted to the other triangular section of the frame. Tighten the webbing strap.

6.6 - Repeat the above procedure with the second black webbing strap, fitted to the frame at position D (Diagram1) again making sure the strap is secure and tightened.

6.7 - Next take the grey strap fitted to the centre front of the elevator frame and pass down to the foot of the bed and then pass underneath. Fasten to the snap clip fitted to the centre rear section of the frame. Tighten the webbing strap.

6.8 - Replace the mattress and using the final grey strap, fitted to the side extension, pass across the top of the mattress and fasten to the snap clip fitted to the other frame extension bar and tighten the webbing strap (see Diagram 2)

6.9 - The bottom sheet may now be fitted.

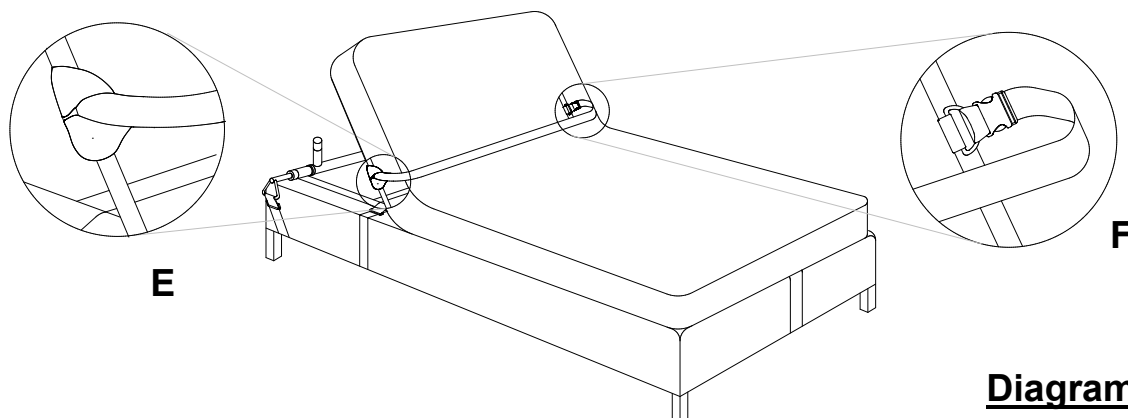
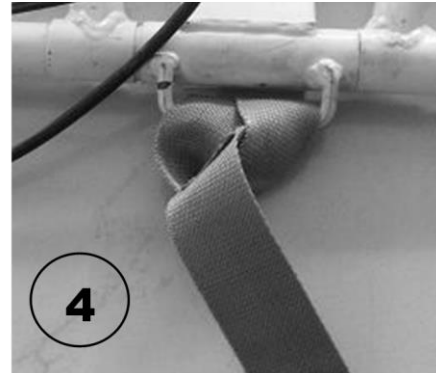
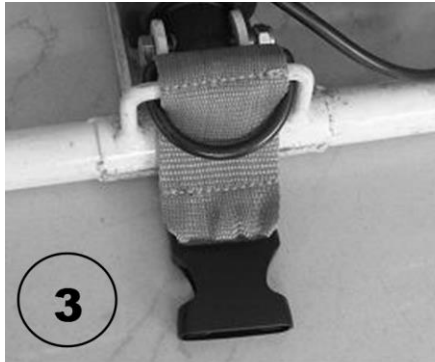

Diagram 2

6.10 - To replace webbing strap.

Attach the short end as shown in picture 3 by passing the clip end of the strap through the frame and then through the plastic “D” ring and pull tight.

Attach the long end of the strap by making a loop through the plastic buckle, then pass this end through the frame and feed the clip end through the loop and pull tight as shown in picture 4



Connection to the Power Supply

The Rise Easy Mattress Elevator is supplied ready for Use.

Before connecting to the mains check the supply voltage is the same as that shown on the control box.

Connect the 13 amp (fused at 3-amp max.) 3 pin plug to the mains.

7 – Operating Instructions

ALWAYS check there are no obstructions before operating the Mattress Elevator.

7.1 – Hold the handset in the correct orientation, with the cable below. Press and hold the “↑ Button” until the desired angle is reached. Note; the actuator will switch off automatically if the maximum angle is reached.

7.2 – To lower the mattress. Press and hold the “↓ Button” on the handset. Note; the actuator will switch off automatically when the lowest position is reached.

Warning: Keep limbs and other body parts clear of all moving parts when operating the mattress elevator, and make sure there are no obstructions when lowering the frame. In the event of an obstruction, the unit is fitted with an anti-crush device, which prevents any further movement of the mechanism. STOP pressing the button immediately. Note; the motor will keep running if the button remains pressed, but there will be further movement.

Remove the obstruction and the product will operate as described above.

Never repeatedly operate a push button if the frame fails to move, i.e. It is jammed, as this can damage the actuator.

8 – Fault Finding

PROBLEM	POSSIBLE CAUSE	REMEDY
Backrest stops sporadically	Safe working load exceeded	Follow safe maximum load guidelines
	Possible fault to the actuator, control box or handset	Call your engineer for help
	Mains cable loose	Check and make sure the cable is fitted securely
	Handset loose	Check connection and push securely into handset socket on actuator
Mattress Elevator is noisy in operation	Actuator needs running in	Run unit a few times to seat the actuator
Actuator is running, but the unit is not moving	Anti-crush device has operated	Remove obstruction
	Faulty actuator or handset	Call your engineer for help
Actuator not running or lifting	Mains cable not plugged in	Check mains cable is plugged in
	Handset not plugged in	Check handset is plugged in
	No power supply to the unit	Check mains supply/ check fuse in plug
Unit moves away from the bed when raising	Straps to base widthways and lengthways are not tight enough	Tighten straps
Mattress creeps down the bed and overhangs the base	Mattress strap is not tight enough	Tighten mattress strap

9 – Care and Maintenance

The Following section is a guide to the recommended care and maintenance procedure for the Mattress elevator; it should be carried out thoroughly and at regular intervals.

Visual check:

Check the anchor straps are under tension, and in good condition, and the frame is positioned correctly on the bed.

Check the frame, control box and handset for wear or damage

Check that all pivot points are free to rotate

Check all welds are sound and there is no evidence of damage

Operational check:

Ensure all parts are moving freely

Complete a full cycle of operation; movement should be smooth with no interruptions.

Cleaning:

Before cleaning ensure the mains plug is removed from the wall socket. DO NOT wet any of the electrical components.

Clean regularly, use a general purpose, neutral detergent and warm water. Do not use an abrasive detergent, cleaner or cloth to clean or dry this product. To disinfect, wipe with a mild chloride disinfectant (solution of 1000 ppm)

If you are in any doubt regarding the maintenance of this product, please contact customer services.

10 – Guarantee

NRS Healthcare, guarantee this product for a period of 12 months from the date of purchase against faulty materials and workmanship. This guarantee does not cover, abuse, misuse, interference or tampering with any part of the product.

Any guarantee issued by NRS Healthcare does not affect your statutory rights.

11 – Spare Parts List

SPARE PARTS LIST	
M53059	Strap Set
M53060	Handset
M53072	Actuator and Control box
M53084	Transformer

12 – Important Information

The information given in these User Instructions must not be taken as forming part of or establishing any contractual or other commitment by NRS Healthcare, its agents or subsidiaries and no warranty or representation concerning the information is given.

Please use common sense and do not take any unnecessary risks when using this product. As the user you must accept liability for safety when using the product.

13 – Technical Information

TECHNICAL SPECIFICATION	
PRODUCT TITLE	Rise Easy Mattress Elevator
PRODUCT WEIGHT	16.5kg (36lb)
SAFE WORKING LOAD	254kg (40 Stones) Total Body Weight
OVERALL SIZE MINIMUM	(W x D x H) 762 x 715 x 155mm 35" x 28" x 6" (Including Actuator)
OVERALL SIZE MAXIMUM	(W x D x H) 1525 x 715 x 780mm 58½ " x 28" x 6" (Including Actuator)
ANGLE OF TILT	10° min. 67°max. Range:57°
CONTROL BOX OUTPUT VOLTAGE	24v DC 10A Nominal
CONTROL BOX INPUT VOLTAGE	220v/240v 50 Hz
<ul style="list-style-type: none">• Handset and actuator approved to EN 50081-1 1992-01-31 and EN 50082-1-1992-30• Actuator and handset housing to IP 54 water ingress• Electric shock resistance and protection to Class II• Actuator and handset tested to EN 60601-1996-03• Mains cable with 13amp, 3 pin plug. Fuse to 3 amp only	

Waste Electrical and Electronic Equipment

The Waste and Electronic Equipment Regulations 2006 (WEEE Regulations) came into effect in the United Kingdom on 1st July 2007. The Regulations have been designed to prevent/reduce the amount of waste electrical and electronic equipment by promoting its reuse, recycling and recovery. The separate collection of WEEE saves energy and resources and avoids hazardous materials going into landfill.

Products which are covered by WEEE regulations have a crossed out Wheelie Bin symbol on either the product itself or its packaging. This symbol aims to encourage you to identify and dispose of WEEE products separately from other waste when it reaches its end of life.

For business purchasers:

NRS is registered with the B2B Compliance Scheme (Registration Number WEE/BK0050TZ). For further details please call the B2B Compliance scheme directly on 01691 676 124

For domestic purchasers:

NRS is registered with the WEEE Distributor Take Back Scheme (Registration Number 7236). For further details on how to dispose of your equipment please go to the scheme website www.recycle-more.co.uk or contact the recycle-more helpline on: 08450 682572 for information on your nearest WEEE collection point. (Please have your post code available).

Note: If you have an old electrical or electronic product that has reached its end of life you can deposit it free of charge for segregation and recycling at Civic Amenity Sites which are registered as Designated Collection Facilities for WEEE.

NRS Healthcare

Sherwood House, Cartwright Way, Forest Business Park, Bardon Hill,
Coalville, Leicestershire, LE67 1UB UK
Tel. Main Office: 0330 100 00 98
Tel. Customer Services: 0845 120 4522
Email: customerservice@nrshealthcare.co.uk

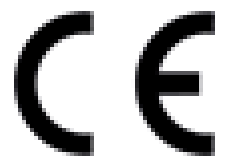

NRS Healthcare is a Leading Supplier of Community Equipment and
Daily Living Aids, to view our full range, visit our website:

www.nrshealthcare.co.uk