

User Instructions

F19959 Divan Over Bed Table

General Safety Warning

Please ensure these instructions are fully read and implemented. Failure to do so may result in injury to the user.

Retain in a safe place for future reference.

Intended Use

For use when sitting in either a chair or bed, to provide an adjustable height/angle table surface for reading, eating etc. It is not to be used as a trolley or designed to be weight bearing.

Contents

	Qty
Base Frame	1
Vertical tubes with pin E-clips	2
Table top with 2 telescopic tubes	1

Assembly and Height Adjustment

1. Unpack all contents, check all parts are present and in good condition before attempting to assemble the table.
2. Assemble the vertical tubes into the base and secure using the pin e-clips. See Fig. 1
3. Slide the two telescopic tubes attached to the table top into the two open tube ends of the side frames (Fig. 2)
4. Adjust the height and angle of the table top as required and tighten hand wheels clockwise to secure (Fig. 2 Inset)

To view a video showing how to assemble and use this product go to:

<https://www.youtube.com/watch?v=lktCkPLI0gM>

Safety Precautions

- Inspect at regular intervals for wear and damage.
- Do not overload table top (10 kg Max load)
- Check hand wheels and E-clips are secure at regular intervals.

Cleaning Instructions

Clean regularly, wiping down with mild detergent /disinfectant solution.

Product Guarantee

NRS Healthcare guarantee this product for a period of 24 months, from the date of purchase, against faulty materials and workmanship.

This guarantee does not cover abuse, interference or tampering with any part of the products. Issues arising from fair wear & tear and customer misuse are not covered.

This guarantee covers domestic use only. If the product is used in commercial or semi-commercial settings such as care homes, schools, rental or communal accommodation etc, the guarantee is valid for one year only. Consumable parts are also guaranteed for one year only.

Any guarantee issued by NRS Healthcare does not affect your statutory rights.

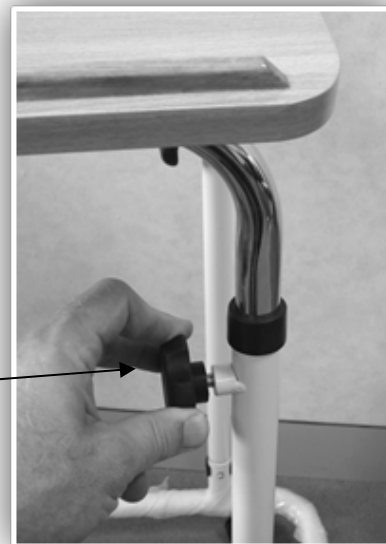
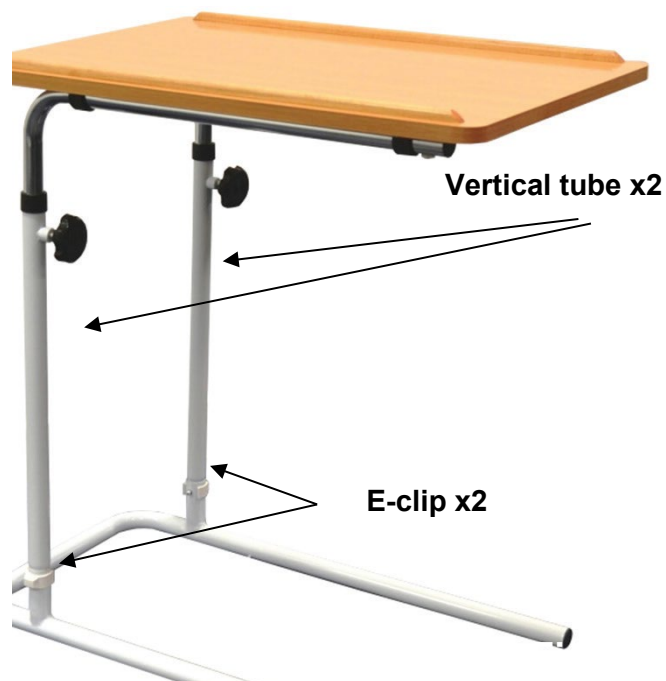

Fig.2

NRS Healthcare,

Sherwood House, Cartwright Way,
Forest Business Park, Bardon Hill,
Coalville, Leicestershire,
LE67 1UB, United Kingdom.

Customer Services: +44 (0)345 121 8111

Email: customerservice@nrshealthcare.co.uk

www.healthcarepro.co.uk or
www.completecareshop.co.uk