

USER INSTRUCTIONS

EASYLIFT HOME - HEIGHT ADJUSTABLE TILTING OVER-BED TABLE

S13909

Height Adjustable Tilting Over-Bed Table

⚠ General Safety Warning ⚠

Please make sure that you read and follow these instructions carefully. Keep these instructions in a safe place for future reference.

1. INTENDED USE

The Easylift Home Over-Bed Table provides users with a firm, flat / tilting surface that is suitable for eating, writing, reading etc. The height adjusts from 710 mm to 1090 mm, and the main tabletop tilts from 0° to 40° degrees. The product is suitable for use with most divan beds, slatted beds, and height adjustable medical beds. The folding side table hides a discrete storage tray.



2. SAFETY



WARNINGS:

- The central column is spring loaded. Make sure the central column hand-wheel is in position & fully tightened before assembly/ disassembly of the table.
- Do not exceed the safe working load of 25 kg (4 st).
- Do not exceed the safe working load of the storage tray 1 kg.

ALWAYS correctly position and adjust the table to allow it to be used safely and comfortably.

DO NOT

- lean or sit on the table.
- put hot objects directly on the table surface.
Maximum heat resistance 65°C (149°F).

MAKE SURE the area is clear before moving the table and that the tabletop is clear before tilting the angle.

TAKE CARE when moving the table over rough or uneven surfaces. Lift the table over large ridges and wide gaps.

ENTRAPMENT HAZARD:

- Do not use this product within 318 mm of headboard or other similar object.
- Take care of fingers when opening and closing the tabletops.
- Always move the table to a safe location when the user is sleeping.

Safe Working Load



3. UNPACKING

Remove the packaging and check all parts carefully. Contact your supplier immediately if parts are missing or damaged and do not try and assemble.

3.1 Contents:

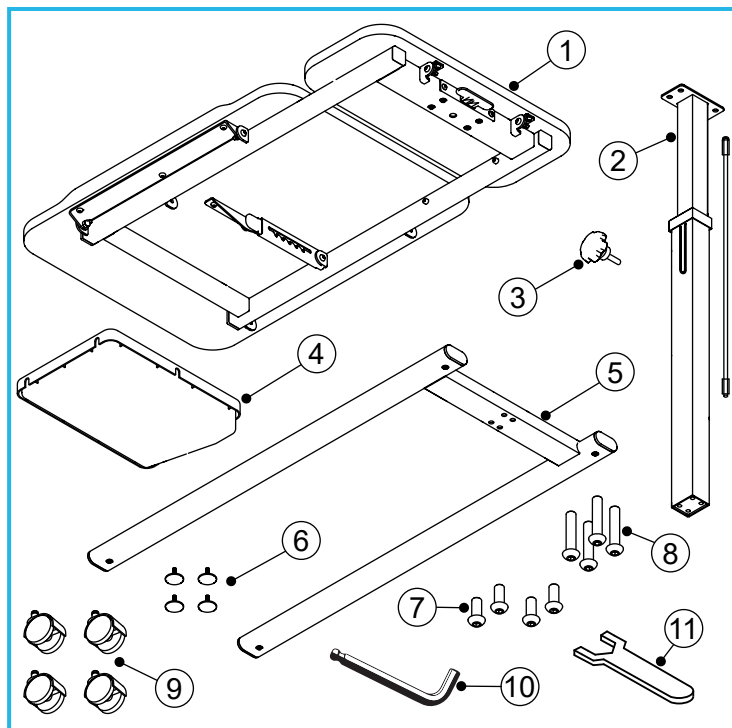

1. Table Top Assembly x 1
2. Column Assembly & Inner Rod x 1
Note: Do not remove the PVC anti-rattle sleeves from either end of the inner rod.
3. Central Column Hand-wheel x 1
4. Storage Tray x 1
5. Base Assembly x 1
6. Mushroom Feet x 4
7. M8 x 20mm Socket-Head Button-Screws x 4
8. M8 x 40mm Socket-Head Button-Screws x 4
9. Castors x 4
10. Allen Key x 1
11. Castor Spanner x 1

4. ASSEMBLY

Note: We recommend a 2 person assembly.

Note: The main tabletop has been pre-installed for a right-hand side use. If you wish to use the over-bed table on the left-hand side of the bed, you will need to change the main table-top orientation before assembly.

4.1 Change the Tabletop Orientation



Warning: Secure the tabletop before performing this operation. The tabletop can swing open causing injury to the user or damage to the tilt mechanism.

4.1.1 Remove Tabletop

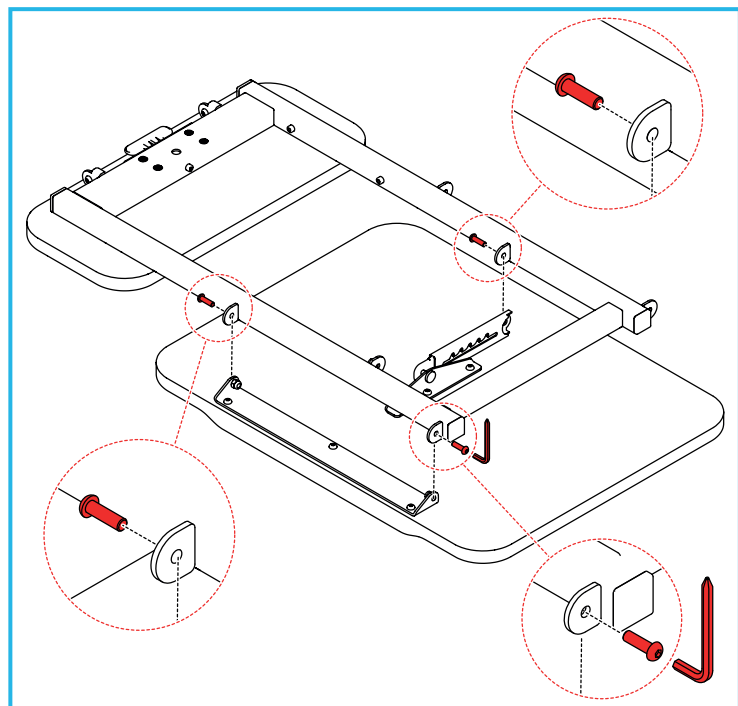

Use the supplied Allen key to remove the 3 x M6 x 20mm screws to release the tabletop from the frame assembly.

4.2 Refit the Tabletop on the Opposite Side

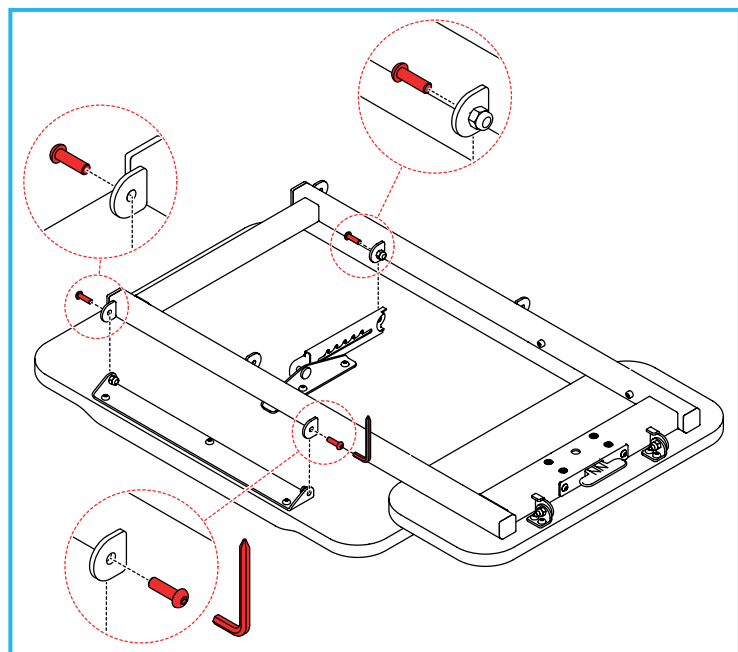

1. Rotate the frame 180 degrees.
2. Re-secure the tabletop to the frame assembly using the Allen key to reinstall the 3 x M6 x 20mm screws.

Note: Make sure the screws are fully tight before you do the next step.

4.3 Fit the Central Column Hand-wheel

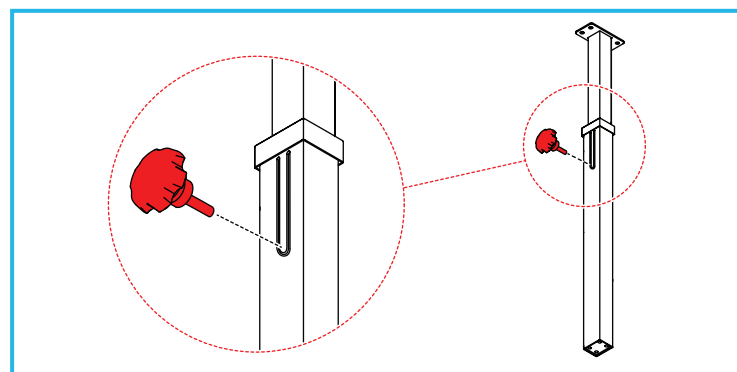

Insert the hand-wheel and turn clockwise to tighten.

4.4 Assemble the Tabletop & Central Column

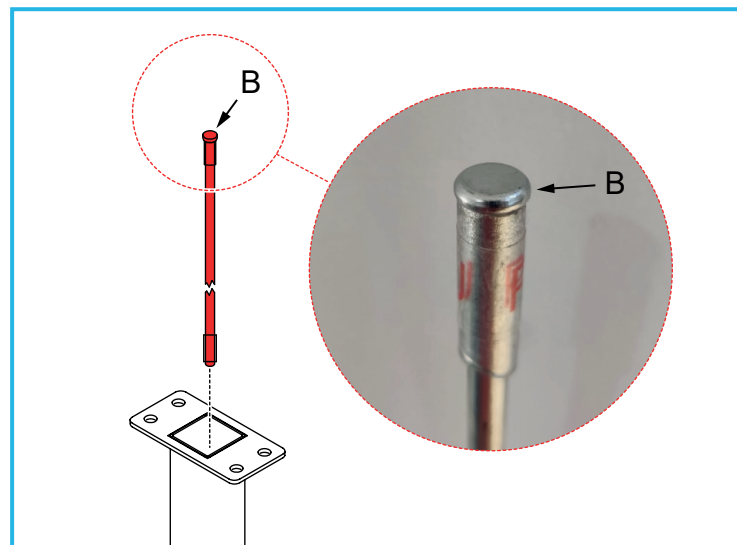

1. Slide the inner rod (B) into the central column.

Note: Make sure the flanged end is facing the correct way up. The plastic anti-rattle cover is marked 'UP'.

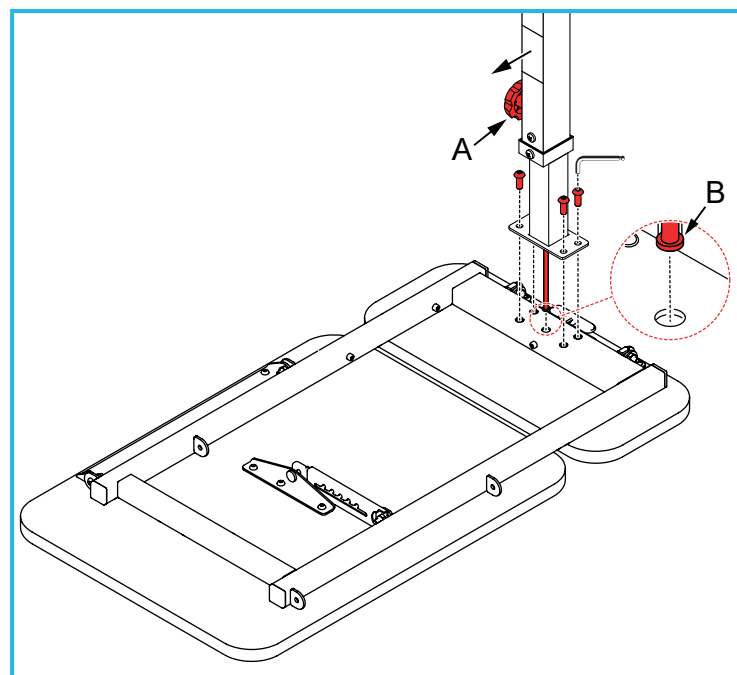

2. Guide the flanged end of the inner rod (B) into the height adjustment lever hole in the main frame.

Note: Make sure the label on the central column is facing inwards before assembly.

3. Secure the column assembly to the table top assembly using the 4 x M8 x 20mm socket head screws and the Allen key provided.
4. Make sure that all four screws are fully tight before you continue the assembly.

4.5 Assemble the Base to the Central Column

Note: Make sure that the base faces the same direction as the table top and the castor inserts face upwards (as shown).

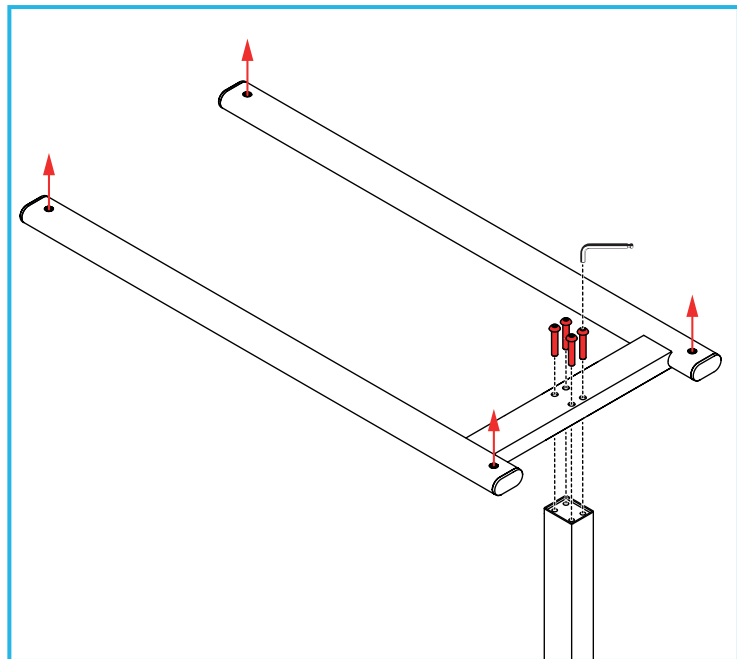

1. Secure the base assembly to the column assembly using the 4 x M8 x 40mm socket head screws and the Allen Key provided.
2. Make sure that all four screws are fully tight before you continue the assembly.

4.6 Fitting the Castors / Feet

4.6.1 Fitting the Castors

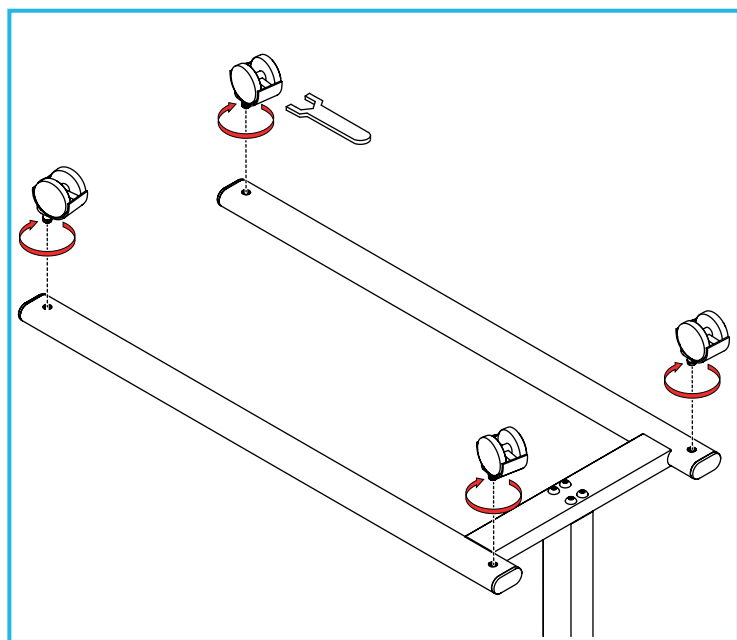

1. Insert the screw thread into the threaded insert, hold the castor and turn the nut by hand until the threads engage.
2. Tighten the castor threads using the 14mm spanner provided.

3. To remove the castors reverse step 1 & 2.

4.6.2 Fitting the mushroom feet

The mushroom feet should be fitted for use with a low base divan.

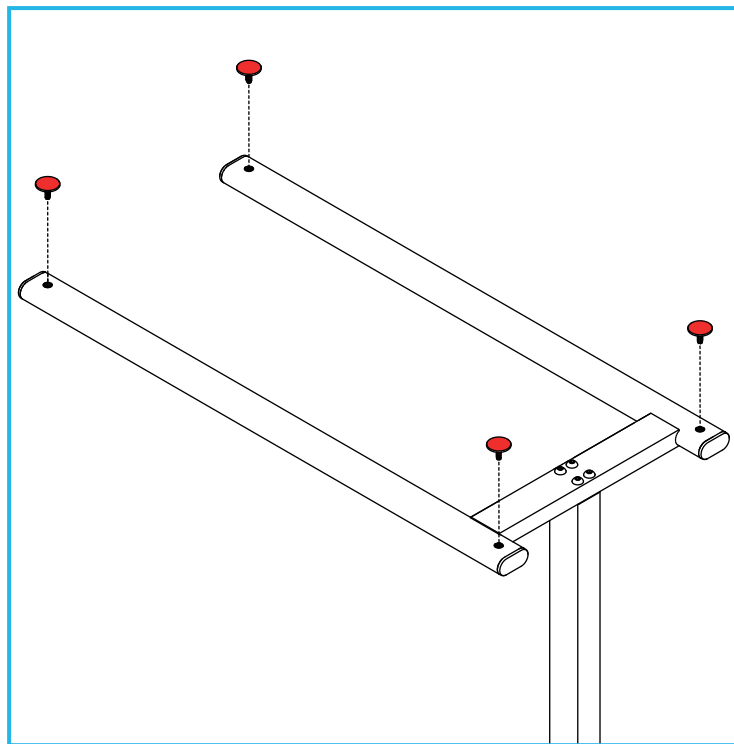

Press-fit the mushroom feet into the castor insert holes.

4.7 Fitting the Storage Tray

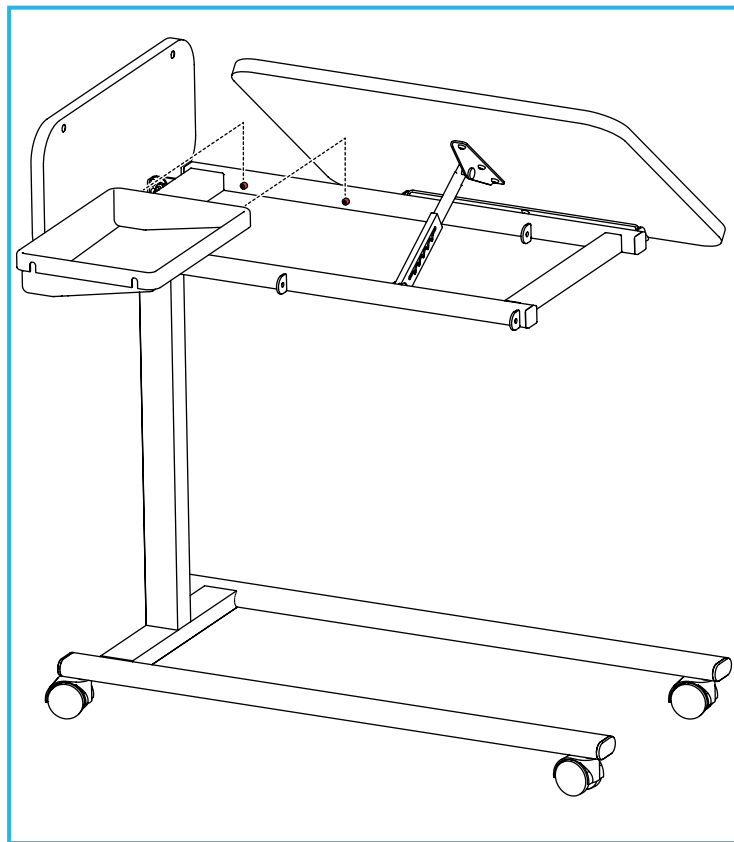

1. Open the side and main table (refer to Section 5.2).
2. Slot the storage tray over the tabs on the table frame as shown.

5. IN USE

5.1 Locking and Unlocking the Brakes.

Note: The table has 4 independently lockable castors. We recommend that the castor locks are always fully engaged when the product is in use or stationary.

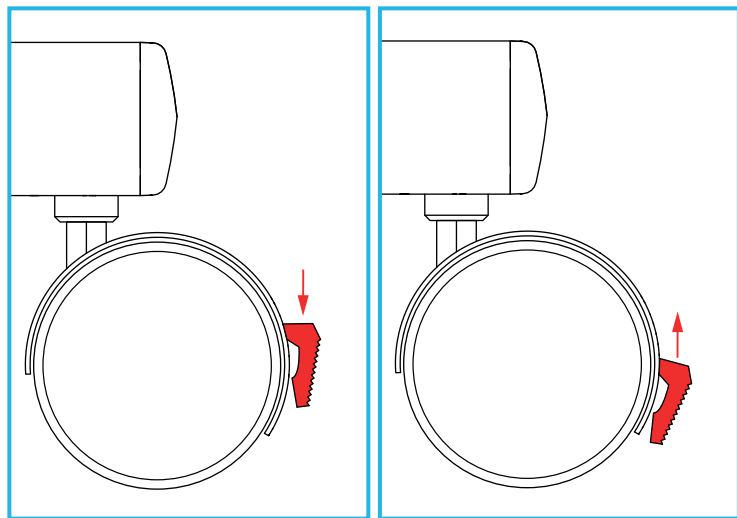
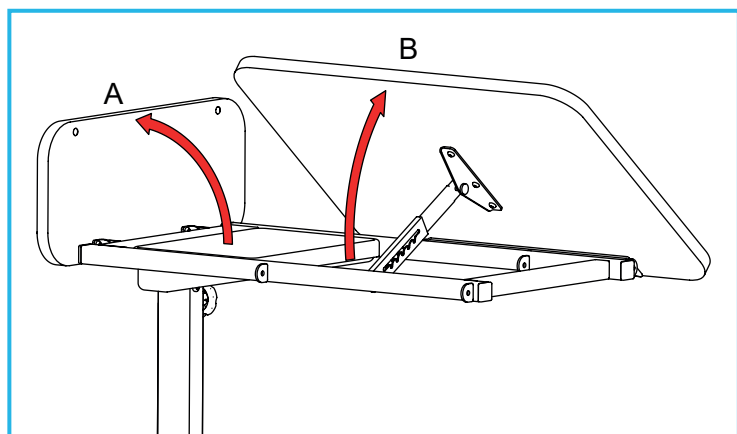

Fig 1: Castor Unlocked

Fig 2: Castor Locked

1. To lock the castor brake, press down on the castor tab (Fig 1).
2. To disengage the castor brake, flip up the castor tab (Fig 2).

5.2 Opening & Adjusting the Tabletops



5.2.1 Open the Side-table.

Note: The side-table has a magnetic lock and requires a small amount of force to open.

To open, pull the side-table in the direction shown (A).

5.2.2 Adjust the Main Tabletop Angle

Note: The main tabletop can be adjusted to the following angles 18°, 24°, 30°, 36° & 40° degrees.

1. Pull the main tabletop towards you until you reach the desired angle (B).
2. Release the tabletop to lock into place.



Warning: Make sure the tabletop has locked into place before releasing fully.

Note: Pulling the tabletop all the way towards you will release the ratchet mechanism. If the tabletop does not lock into position, return the tabletop to the horizontal position to reset the ratchet mechanism.

5.3 Closing the Tables

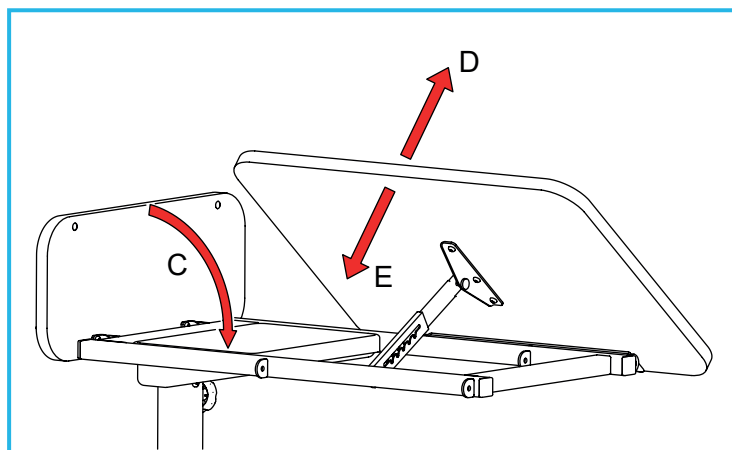

5.3.1 Close the Side Table

Lower the side table to the horizontal position (C).

5.3.2 Close the Main Tabletop

1. Pull the main table all the way towards you to release the ratchet mechanism (D).
2. Gently lower the main tabletop to the horizontal position (E).



Warning: Do not let the tabletop drop as this will cause damage to the tilt mechanism, or cause injury to the user.

5.4 Raising & Lowering the Table

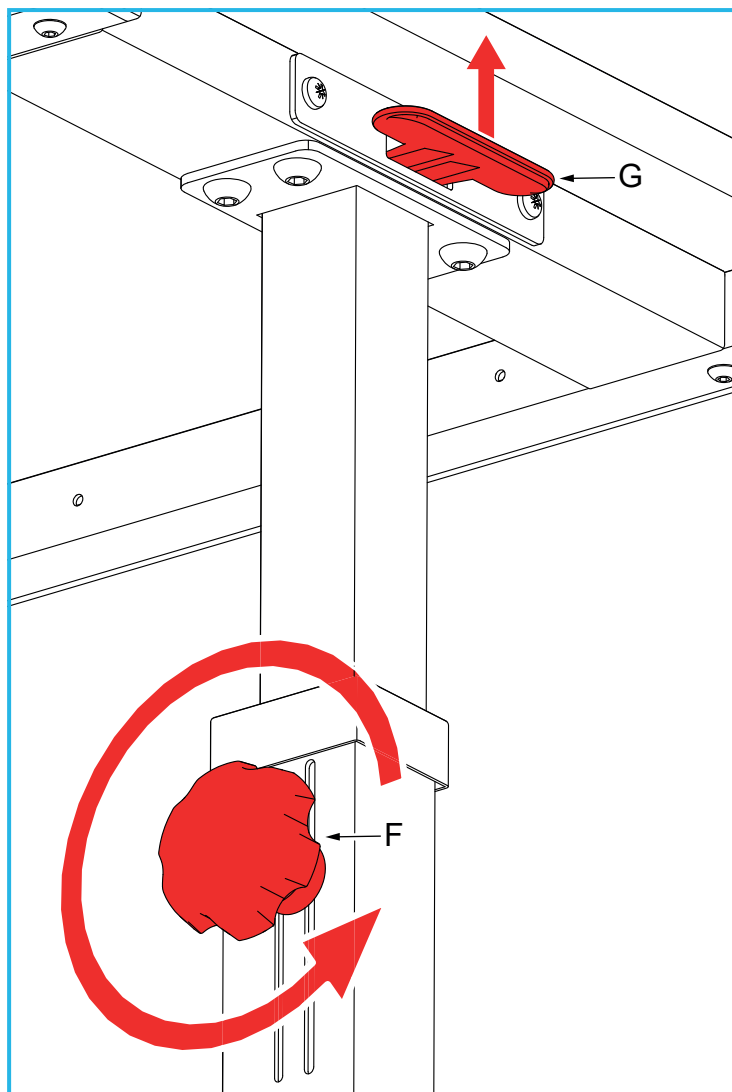

1. To release the central column, unscrew the locking hand-wheel (F) by turning anti-clockwise.

2. Pull lever (G) up to release the spring mechanism, then simultaneously raise or lower the table-top into position.
3. To lock the central column, screw the locking hand-wheel (F) clockwise.

accommodation etc, the guarantee is valid for one year only. Consumable parts are also guaranteed for one year only.

Any guarantee issued by NRS Healthcare does not affect your statutory rights.

6. MAINTENANCE

Regularly check the wheels rotate freely.

Regularly check the tilting ratchet mechanism functions correctly.

Regularly check the brakes function correctly in accordance with Section 5.1.

Always check the locking hand-wheel is fully tight before use.

Make sure the hand-lever is functioning correctly.

7. CLEANING INSTRUCTIONS

We recommend removing the storage tray before cleaning.

Please check the suitability of the cleaning products before use. Do not use abrasive cleaners or cloths as these could permanently damage the surface and invalidate any warranty.

Do not use solvents to clean the product.

Make sure that all dirt and debris is removed from around the wheels.

Make sure that all dirt and debris is removed from the tilting ratchet mechanism.

Clean regularly using a general purpose, neutral detergent and warm water.

To disinfect, wipe with a dilute bleach solution, and rinse thoroughly with fresh water.

Allow product to fully dry prior to use/storage.

8. ACCESSORIES & SPARE PARTS

S20161: Spares Kit

- Replacement Mushroom Feet (set of 4).
- Replacement Castors (set of 4).

S39510: Spare Storage Tray.

9. PRODUCT DISPOSAL

This product must be thoroughly cleaned/sterilised prior to disposal.

This product is manufactured from metal, wood & plastic and can be disposed of through Local Authority Household Waste and Recycling Centres or through Local Trade Waste Collectors.

10. PRODUCT GUARANTEE

NRS Healthcare guarantee this product for a period of 24 months, from the date of purchase, against faulty materials and workmanship.

This guarantee does not cover abuse, interference or tampering with any part of the products. Issues arising from fair wear & tear and customer misuse are not covered.

This guarantee covers domestic use only. If the product is used in commercial or semi-commercial settings such as care homes, schools, rental or communal

NRS HEALTHCARE Sherwood House, Cartwright Way, Forest Business Park
Bardon Hill, Coalville, Leicestershire, LE67 1UB, UK.

Tel: Customer Services: +44 (0)345 121 8111

Email: customerservice@nrshealthcare.co.uk

NRS Healthcare is a leading supplier of community equipment and daily living aids.
Please visit one of our websites to view our full range of products:
www.healthcarepro.co.uk or www.completecareshop.co.uk