



*Exclusively designed & developed  
by NRS Healthcare*

# Atlas Advance

**Turning & Transfer Aid**

*Product code: P11437*



# Atlas Advance

## Turning & Transfer Aid

Atlas Advance is the next generation of moving and handling equipment from NRS Healthcare, designed with the comfort, safety and ergonomics of both caregiver and user in mind.

Atlas Advance assists easier movement of the user from sitting to standing (and vice versa) with the help of a carer. Its unique, four bar handle design makes it suitable for users of different heights, enabling them to easily reach the nearest bar to pull themselves to standing, without straining or stretching. The contoured, padded dual knee pads are height and width adjustable for user comfort.

Atlas Advance has four castors and two central wheels, allowing effortless transferring of the user for short distances in the home. The central wheels can be locked simultaneously using one of the two brake levers on either side. Plastic bumpers cover the castors at the front and back, to protect furniture from knocks and scrapes.

The standing platform is covered with a non-slip mat for the user's safety, and is low in height to fit under most divan beds and to make it easy for the user to step onto.

Atlas Advance is suitable for use with people who can support their own weight. It can help the user to stay active: pulling themselves up into position and using their own strength and muscles.

An optional Safety Belt may be purchased separately to ensure safe transfers across short distances, or for those users who may benefit from a greater sense of security when standing. The Safety Belt fixes easily to a choice of two fixing points depending on the height of the user. The belts are available in three sizes and feature colour coded loops for correct and secure fitting.

Easy to assemble, the handle section fixes to the base with two knobs, requiring no tools. The Atlas Advance is suitable for users up to a maximum user weight of 155kg/24st.



Assists with sitting to standing



User has a choice of hand hold positions



User is ready to transfer



# Key features

- Four bar handle
- Optional Safety Belt in 3 sizes
- Choice of safety belt fixing points
- Contoured, padded, height & width adjustable, dual knee pads
- Twin linked brake levers
- Easy to manoeuvre - 4 castors & 2 wheels
- Non slip mat
- Plastic protective bumpers
- Low height platform
- Cutout fits around toilet



Secure transfers using Safety Belt



Twin linked brake levers



Safety Belt available in three sizes - colour coded loops

# Specification

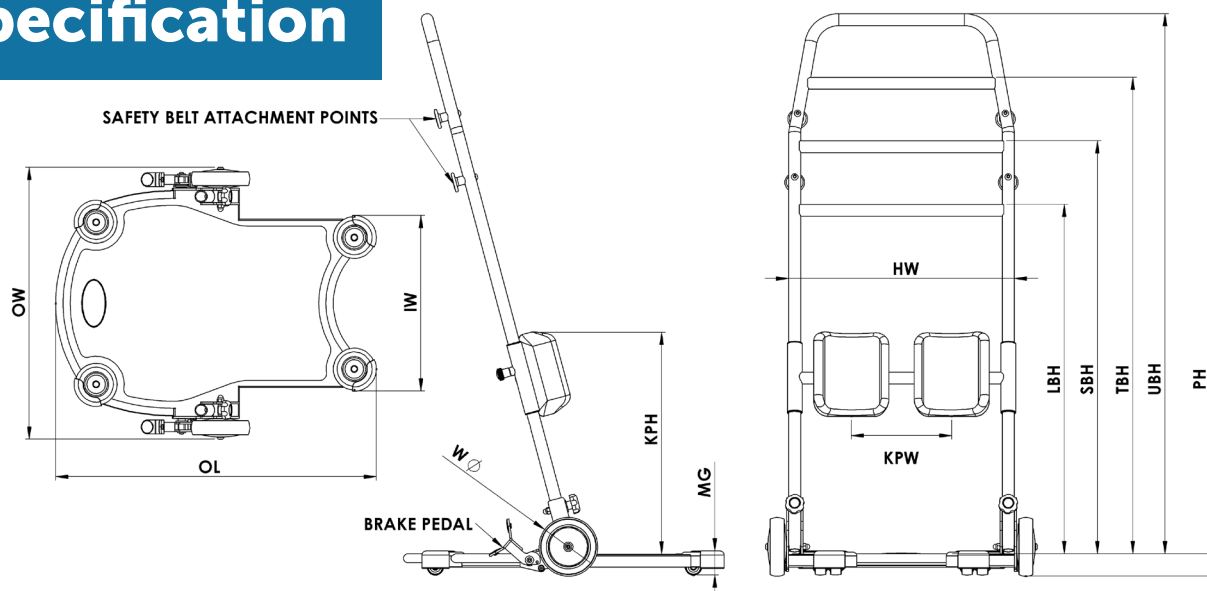

Symbol	Description	Dimension
OW	Overall Width	579mm (22 <sup>3</sup> / <sub>4</sub> "
OL	Overall Length	683mm 26 <sup>7</sup> / <sub>8</sub> "
IW	Inside Width	374mm (14 <sup>3</sup> / <sub>4</sub> "
WØ	Wheel Diameter	125mm (5")
KPH	Knee Pad Height	356-472mm (14-18 <sup>5</sup> / <sub>8</sub> "
MG	Min. Gap Under Bed	52mm (2")
HW	Handle Width	480mm (18 <sup>7</sup> / <sub>8</sub> "
KPW	Knee Pad Width	162-262mm (6 <sup>3</sup> / <sub>8</sub> -10 <sup>1</sup> / <sub>3</sub> "
LBH	Lower Bar Height	744mm (29 <sup>1</sup> / <sub>3</sub> "
SBH	Second Bar Height	880mm (34 <sup>5</sup> / <sub>8</sub> "
TBH	Third Bar Height	1015mm (40")
UBH	Upper Bar Height	1150mm (45 <sup>1</sup> / <sub>3</sub> "
PH	Platform Height	48mm (1 <sup>7</sup> / <sub>8</sub> "
-	Max. User Weight	155kg (24st)

Product Code	Product Name
P11437	Atlas Advance Transfer Aid
P11449	Safety Belt - Small
P11450	Safety Belt - Medium
P11462	Safety Belt - Large

Also available from NRS Healthcare...

## Atlas 2 Transfer Disc

Product code: N43504

A lightweight turning aid with height adjustable, independently pivoting knee pads and height adjustable handles.



**For more information or to place an order, please contact your local Area Sales Manager or the NRS Healthcare Customer Service Team:**

**Telephone: 0345 121 8111**

**Email: [customerservice@nrshealthcare.co.uk](mailto:customerservice@nrshealthcare.co.uk)**

**[www.nrshealthcare.co.uk](http://www.nrshealthcare.co.uk)**



Book a demonstration of the Atlas Advance - email: [demonstrations@nrshealthcare.co.uk](mailto:demonstrations@nrshealthcare.co.uk)

For international enquiries, please telephone: +44 (0)1530 232 292  
or email: [exportsales@nrshealthcare.co.uk](mailto:exportsales@nrshealthcare.co.uk)

Leaflet code: P11693