

# USER INSTRUCTIONS

## FOLDING EASYFIT BED RAIL

P42809

Folding EasyFit Bed Rail (with straps)

### ⚠ General Safety Warning ⚠

Please make sure that you read and follow these instructions carefully. Keep these instructions in a safe place for future reference.

### 1. INTENDED USE

To provide stable support to aid adult users (taller than 1.46 m) transfer in and out of bed, moving from a lying to a sitting position as well as assist user repositioning. This product is suitable for all sized divan and framed beds, and can be fitted to either side of the bed. Supplied with bed rail straps for additional security.



### 2. SAFETY

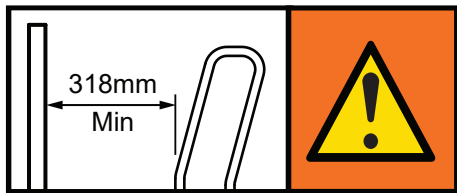

**WARNING:** To avoid possible entrapment, you must always position the product a minimum of 318 mm from the headboard or footboard.

**WARNING:** To prevent additional entrapment hazards, we recommend that you install the product at least 318 mm away from any adjacent bedside furniture. Where this is not possible, the prescriber must do a risk analysis.

**WARNING:** The maximum user weight must not be more than 127 kg (20 st).

**YOU MUST** carry out a risk assessment to assess the use and suitability of the bed rail in relation to the users physical and cognitive ability, as well as the surrounding environment.

**DO NOT** install this product to a damaged bed.

**MAKE SURE** there is no gap between the bed rail and the mattress.

**ALWAYS** use the bed securing straps provided when fitting to a divan bed.

**REGULARLY** check the straps are tight and the device is stable and firmly fitted.

**DO NOT** fit this product to medical or profiling beds.

### 3. UNPACKING

Remove the packaging and check all parts carefully. Contact your supplier immediately if parts are missing or damaged and do not try and assemble.

### Maximum User Weight

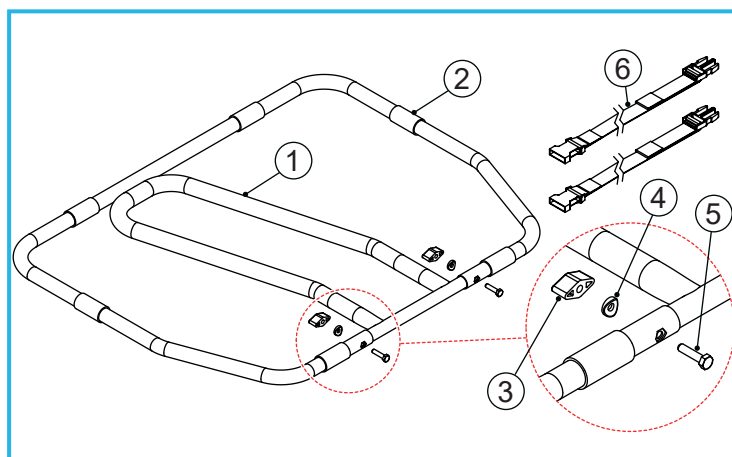

Figure 1: EasyFit Bed Rail Assembly

#### 3.1 Contents

**Note:** The Folding EasyFit Bed Rail is supplied pre-assembled in the folded position.

- |                          |                               |
|--------------------------|-------------------------------|
| 1. Bed Rail Handle       | 4. Plastic Saddle-Washers x 2 |
| 2. Bed Rail Base         | 5. Steel Bolts x 2            |
| 3. Plastic Wing-Nuts x 2 | 6. Bed Rail Straps            |

### 4. ASSEMBLY

1. Refer to Figure 1. The bed rail handle (1) can be rotated in both directions, please make sure it is in the correct position for your installation.
2. Unscrew the two plastic wing-nuts (3), then remove the two plastic saddle-washers (4) and the two bolts (5).

#### 4.1 Right-Hand Side Assembly

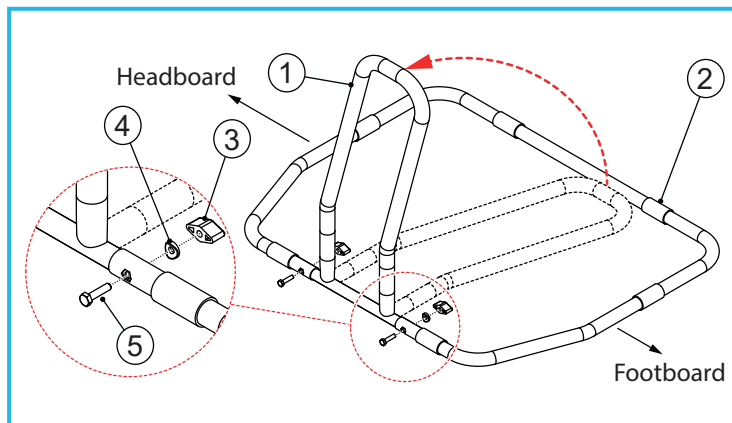
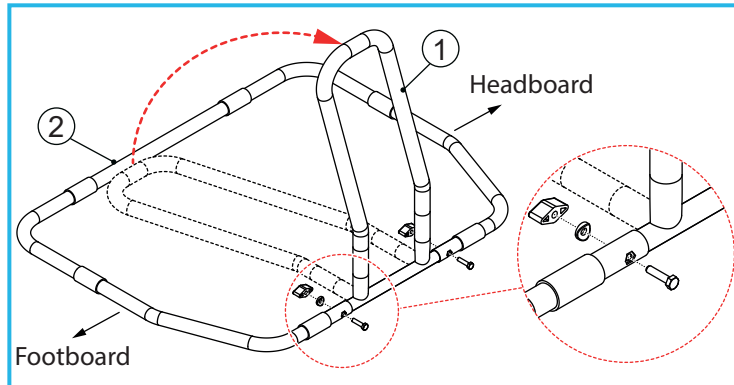

Figure 2: RHS Assembly

1. Refer to Figure 2. Position the bed rail base (2) as shown.
2. Rotate the bed rail handle (1) 90 degrees.
3. Insert the bolts (5) into the holes, making sure they locate fully into the hexagonal recess.
4. Replace the two saddle-washers (4) and secure with the two plastic wing-nuts (3).
5. Make sure the bed rail handle (1) is fully secure before installing to the bed.

#### 4.2 Left-Hand Side Assembly



**Figure 3: LHS Assembly**

1. Refer to Figure 3. Position the bed rail base (2) as shown.
2. Rotate the bed rail handle (1) 90 degrees.
3. Refer to Section 4.1. Repeat steps 3 to 5.

### 5. INSTALLATION

#### 5.1 Fitting to a Divan Bed

**WARNING:** You must use the straps provided when fitting to a divan bed. An unsecured bedrail could move causing risk of entrapment.

##### 5.1.1 Position the Bed Rail

1. Remove the mattress and place the bed rail onto the base of the bed.

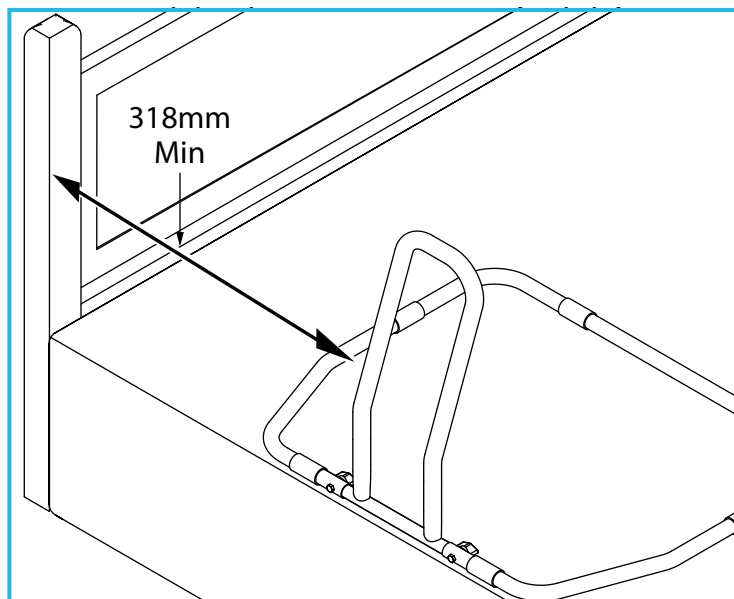

2. Position the bed rail so the user can reach the handle from a relaxed lying position without having to stretch.

**WARNING:** To avoid possible entrapment, you must always position the product a minimum of 318 mm from the headboard or footboard.

#### 5.1.2 Fitting the Straps

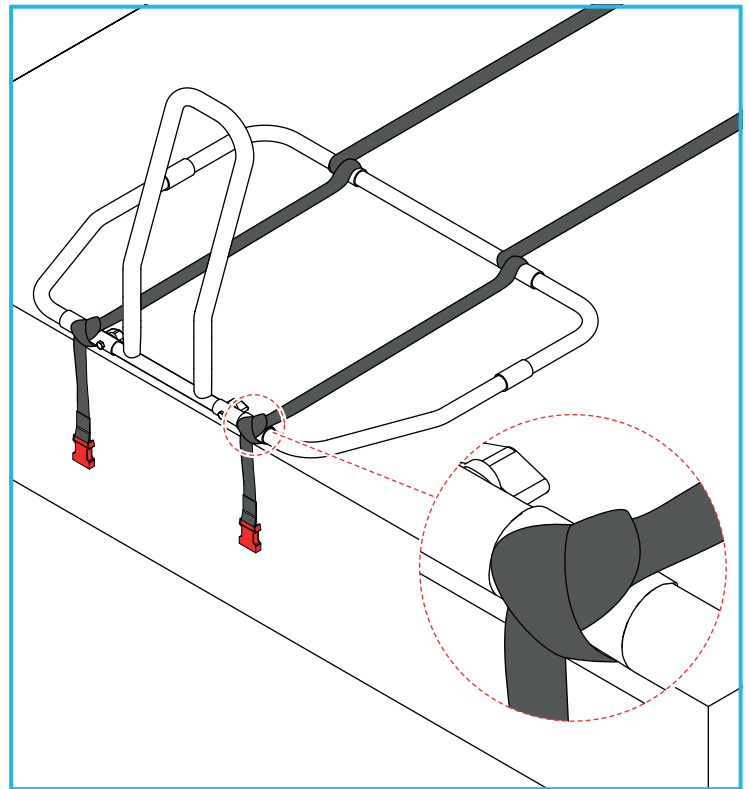

With the first strap, tie a secure knot on the hand rail assembly in the position shown, then repeat for the opposite site with the second strap.

**Note:** The strap buckle should hang down the side of the bed between 50 to 75 mm.

#### 5.1.3 Securing the Straps

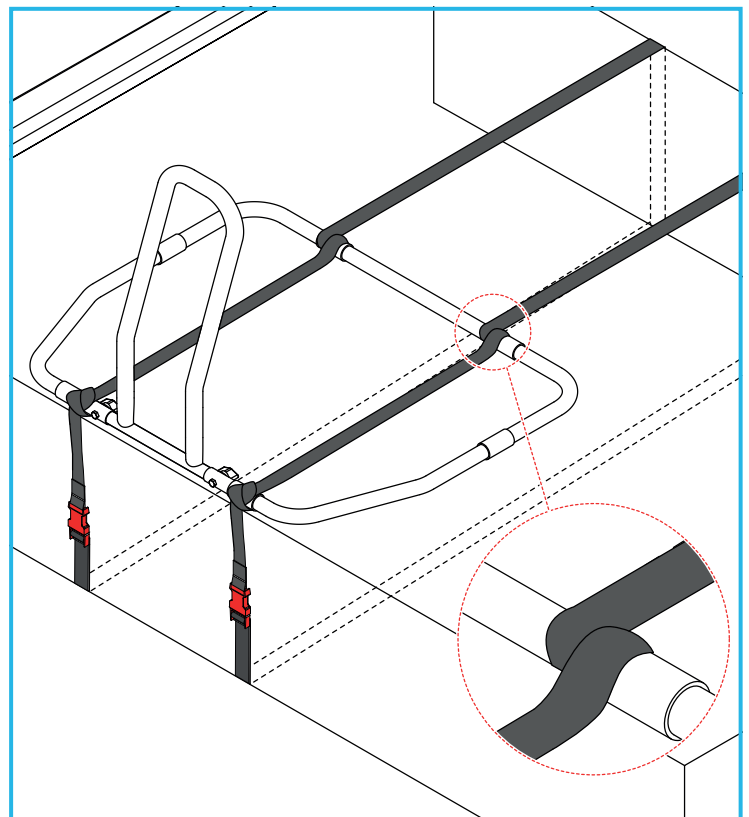

1. Loop the first strap around the bed rail base in the position shown.
2. Feed the strap over the top of the bed and back underneath the base.

**Note:** To fit the strap under the divan base, take the strap to the end of the divan base, lift up the end of the divan base and feed the strap underneath the legs / castors.

3. Clip the two strap buckles together.
4. Pull down on the loose end of the strap to tighten.
5. Make sure the bed rail base is tight against the divan base.

**Note:** To avoid tripping hazards, make sure you tuck away any loose strap ends.

6. Repeat for the second strap on the opposite side of the bed rail.
7. The bed rail should now be fully secured to the divan base.

## 5.2 Fitting to a Framed Bed with Fixed Slats

### 5.2.1 Position the Bed Rail

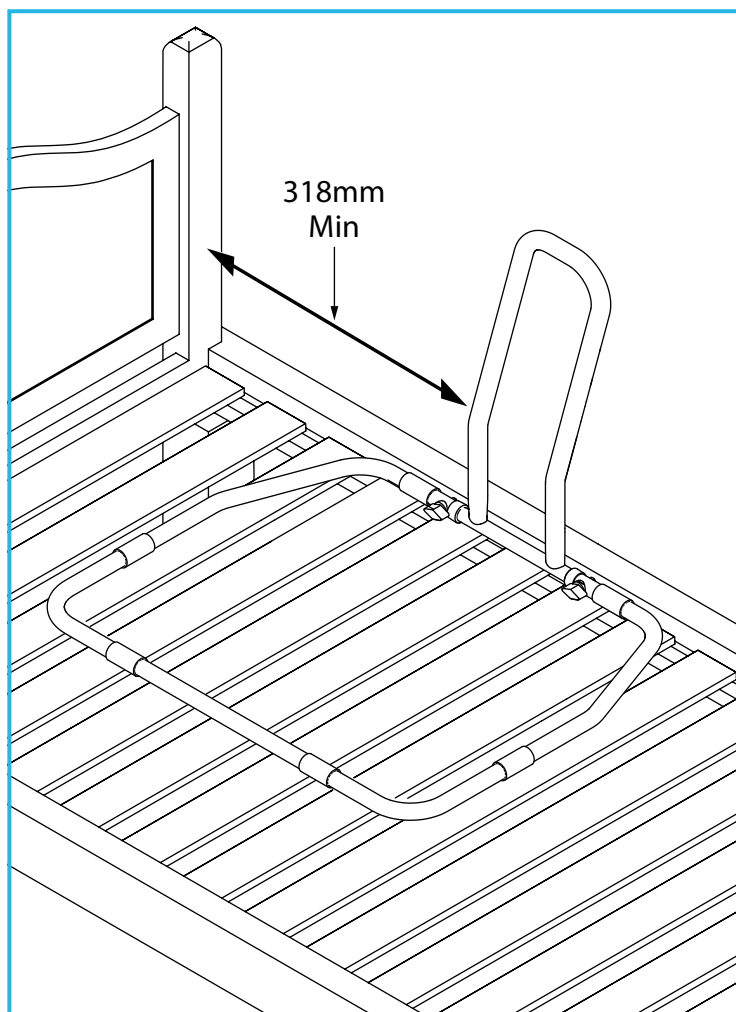

1. Remove the mattress and place the bed rail onto the base of the bed.
2. Position the bed rail so the user can reach the handle from a relaxed lying position without having to stretch.

**WARNING:** To avoid possible entrapment, you must always position the product a minimum of 318 mm from the headboard or footboard.

### 5.2.2 Fitting with Straps

**Note:** If the bed has securely fixed slats, we strongly recommend securing the bedrail with the straps provided using the method below:

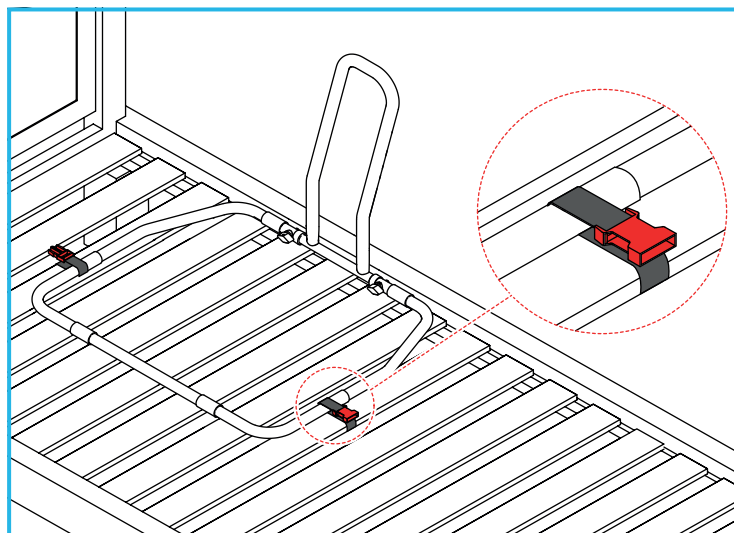

1. Thread one end of the strap from under the bed up around the bed slat, then thread around the bed rail base as shown.
2. Repeat the step using the other end of the strap on the opposite side of the bed rail base.

### 5.2.3 Securing the Straps

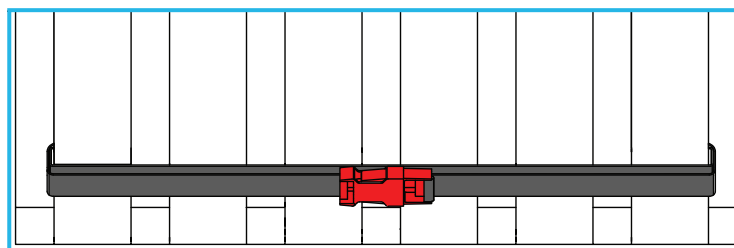
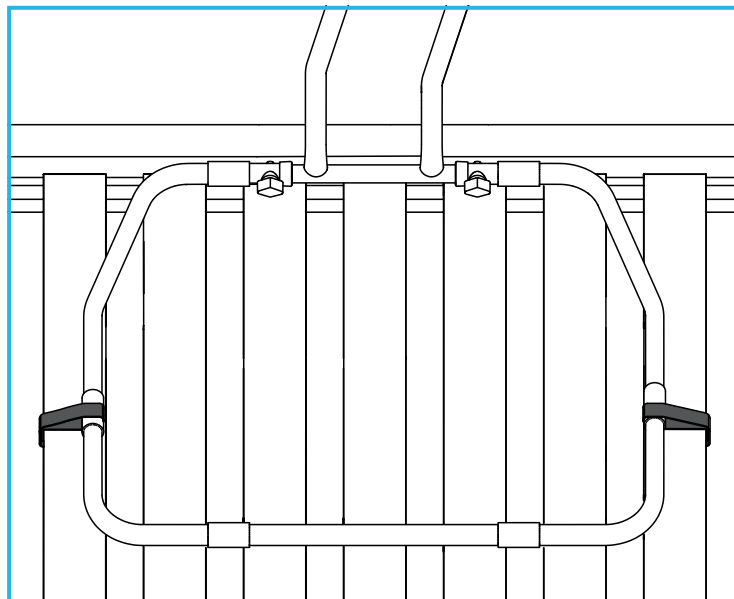

#### Underside of the Bed

1. Pull both buckles so they meet in the middle on the underside of the bed, then clip together.
2. Pull down on the loose end of the strap to tighten.

**Note:** To avoid tripping hazards, make sure you tuck away any loose strap ends.

3. Make sure the bed rail is fully secure before replacing the mattress.

### 5.3 Fitting to a Framed Bed with Non-Fixed Slats

**Note:** Straps cannot be used on a bed with non-fixed slats.

Repeat the steps in section 5.2, but do not use straps.

1. Replace the mattress, making sure there is no gap between the bed rail and the mattress.

## 6. CLEANING

### 6.1 Cleaning the Hand Rail & Base

Please check the suitability of the cleaning products before use. Do not use solvents, abrasive cleaners or cloths as these could permanently damage the surface and invalidate any warranty.

Clean the frame regularly, using a general purpose, neutral detergent and warm water.

To disinfect, wipe with a dilute bleach solution, and rinse thoroughly with fresh water.

Allow product to fully dry prior to use/storage.

### 6.2 Cleaning the Straps

Clean with sponge and warm soapy water, then rinse thoroughly with fresh water.

Allow product to fully dry before use/storage.

Do not use bleach or solvents.

## 7. MAINTENANCE

**Note:** The following checks should be carried out on a daily basis.

Check the wing-nuts are fully tightened and that there is no excessive movement.

Check that the bed rail is correctly positioned (minimum of 318 mm from the headboard or footboard).

Make sure there is no gap between the bed rail and the mattress.

Inspect the product for signs of wear or damage at regular intervals.

Any suspected faults or damage must be reported to the supplier and the product taken out of use immediately.

## 8. ACCESSORIES & SPARE PARTS

**L75930:** Bed Rail Strap

**P43062:** (2 x Plastic Wing-Nuts, 2 x Plastic Saddle-Washers & 2 Steel Bolts).

For more details please visit our website:

[www.nrshealthcare.co.uk](http://www.nrshealthcare.co.uk) or call Customer Services.

## 9. PRODUCT DISPOSAL

This product should be thoroughly cleaned prior to disposal.

This product is manufactured from metal and plastic and can be disposed of through Local Authority Household Waste and Recycling Centres or through Local Trade Waste Collectors.

## 10. PRODUCT GUARANTEE

NRS Healthcare guarantee this product for a period of 24 months, from the date of purchase, against faulty materials and workmanship.

This guarantee does not cover abuse, interference or tampering with any part of the products. Issues arising from fair wear & tear and customer misuse are not covered.

This guarantee covers domestic use only. If the product is used in commercial or semi-commercial settings such as care homes, schools, rental or communal accommodation etc, the guarantee is valid for one year only. Consumable parts are also guaranteed for one year only.

Any guarantee issued by NRS Healthcare does not affect your statutory rights.

If you have any problems with our products, please contact us at the address below.

If you have experienced an injury, contact us but feel free to contact the Medicines and Healthcare products Regulatory Agency at:

[devices.regulatory@mhra.gov.uk](mailto:devices.regulatory@mhra.gov.uk)



**NRS HEALTHCARE** Sherwood House,  
Cartwright Way, Forest Business Park, Bardon  
Hill, Coalville, Leicestershire, LE67 1UB, UK.



**NRS HEALTHCARE** 4C Altona Road, Blaris  
Industrial Estate, Lisburn, Co Antrim,  
Northern Ireland BT27 5QB

Tel: Customer Services: +44 (0)345 121 8111

Email: [customerservice@nrshealthcare.co.uk](mailto:customerservice@nrshealthcare.co.uk)

**NRS Healthcare** is a leading supplier of community equipment and daily living aids.

Please visit one of our websites to view our full range of products:

[www.healthcarepro.co.uk](http://www.healthcarepro.co.uk) or [www.completecareshop.co.uk](http://www.completecareshop.co.uk)