

User Instructions

M00789 - Economy Wall Mounted Shower Seat



Maximum
User
Weight



General Safety Warning

Please ensure these instructions are fully read and implemented. Failure to do so may result in injury to the user. Retain in a safe place for future reference.

Intended Use

This Shower seat is intended to be used in a bathroom or shower, to provide a stable seated surface for clients with reduced mobility who are unable to stand during showering. It can be folded up against the wall when not in use.

Specification

Max User Weight: 136 Kg (21½st)

Unpacking

Remove the product from its packaging, check thoroughly, if you see any damage or suspect a fault do not assemble the product, contact your supplier immediately.

Safety Precautions

- This shower seat must be correctly installed and maintained.
- It is recommended that this product should only be installed by a suitably qualified, competent person.
- Only install the product in an area where the mounting surface is structurally sound. (Strengthening modifications to the fixing surface may be required).
- This product must only be secured to the wall using fasteners that are appropriate to the structural base material.
- DO NOT install in fibreglass/acrylic shower enclosures with insufficient stiffness and strength.
- The Maximum user weight of this product is 136kg (21½st) based on the product being fitted to a suitable surface using appropriate fixings by a competent person.
- Inspect the product at regular intervals for wear damage and instability, do not use if you suspect a fault.



Fitting and Height Adjustment

1. Identify the correct height and position for the seat within the shower.
2. With the seat in the down position and the seat legs firmly in contact with the shower base and at 90 degrees to the wall, adjust leg extension tubes to the correct height for the client.
3. Mark the fixing positions for the wall mounting brackets on the wall.
4. Using appropriate, non rusting screws and fixings, secure brackets to the wall.
5. Check that seat may be raised and lowered without interference, and that the feet are securely in contact with the shower base.
6. Check seat is firm and secure.

Using the Shower Chair

1. Pull seat down from wall, ensuring both legs are level and in contact with the shower floor.
2. Test lightly with hands before sitting.
3. Sit centrally on the shower seat.
4. Raise the seat when not in use.

Cleaning Instructions

- Clean regularly, wiping down with mild detergent/disinfectant solution.
- Do not use abrasive Cleaner.

Maintenance

- Inspect the product on a regular basis.
- Check stability and rigidity.
- Inspect for wear and damage.
- Check wall fixings are secure and show no signs of rusting.
- Do not use if unstable or the rubber feet are damaged.

The **Economy Wall Mounted Shower Seat** is part of a range of over 3000 daily living aids available from NRS Healthcare. To view the full range please visit our website www.nrs-uk.co.uk. Or request a catalogue from the number below.

NRS Products you may find useful from our range of bathroom accessories:

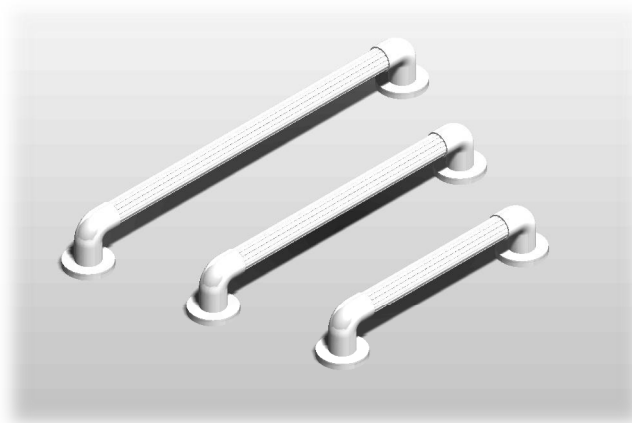

Fluted Grab Rail Range:
F19467 - 300mm White
F19479 - 450mm White
F19480 - 600mm White



Corner Shelf
Product Code: M66376



Soap Dish
Product Code: M66388

IMPORTANT

For information on how to obtain the User Instructions in other languages and formats for use by people with visual, reading or cognitive impairments, please contact: info@nrs-uk.co.uk or telephone: 0845 120 4522.

Additional copies of this user instruction are available on our website: www.nrs-uk.co.uk

NRS Healthcare

Sherwood House, Cartwright Way
Forest Business Park, Bardon Hill
Coalville, Leicestershire. LE67 1UB UK

Tel: 0845 120 4522 Fax: 0845 121 8112
Email: customerservice@nrs-uk.co.uk

www.nrs-uk.co.uk

